



**FORESTRY AND ARBORICULTURAL GROUP
TREE REPORT**

Hermitage Road Play Area

Whitwick

27th April 2026

SURVEYOR: Rob Hardingham



CONTENTS

- 1 General Tree Statement
- 2 Tree Works
- 3 Recommendations
- 4 Appendices

Included separately to this report.

- Tree survey schedule
- Site Maps

PURPOSE

This report has been prepared for Hermitage Road Play Area as part of the tree safety survey conducted on 06th April 2026. It includes twenty-two individual trees, and three tree group spread over the site.

Details for the individual trees may be found in the separate accompanying schedule.

SURVEY METHODOLOGY

The survey has been conducted from ground level and has included a close visual inspection of the external features of all significant trees on the site. The trees are plotted and numbered on the enclosed plans and details of each individual tree are given on the survey schedule attached.

Where an identified defect represents a potential hazard to users of the site, recommendations for remedial tree work have been detailed against individual trees. These works have been prioritised into the categories specified below and are detailed within the attached schedule.

FINDINGS

Recommendations for remedial works have been made in the survey under Priority 2 works only. These trees have been identified as requiring attention at the time of the survey. You are advised to take the necessary steps to arrange for the recommended work to be completed.

'High Risk' trees are large trees close to busy areas with one or more significant defects that potentially threaten the structural integrity of the tree. These trees may be required to be re-inspected every 18 months. Any trees in this category will be highlighted in the report. All trees on this site (unless otherwise stated) should be considered as 'Moderate Risk' due to the open public aspect of the site and re-inspected every 3 years.

Routine works are those that may be picked up as part of your routine ground's maintenance cycle over three years. In some cases, these may be works that could be carried out by your own ground staff at no additional cost.

All trees should be kept routinely clear of ivy so that any evidence of poor health or safety concerns can be identified. Where trees have not been inspected due to excessive ivy, it is possible that they may not be covered by your insurance in the event of an incident. They should therefore be cleared and booked in for re-inspection as soon as possible.

1. GENERAL TREE STATEMENT

Twenty-two individual trees and three tree groups were surveyed and were generally found to be in good health for their age, species and context. There are a number of mature trees on site which exhibit a range of characteristics commensurate with their age and maturity.

Works have been recommended to one tree and two tree groups (I have marked the trees that require work in the groups with yellow paint) on the site. Some trees would benefit from the removal of excessive ivy which increases the risk of failure due to excess weight on weak limbs and places excessive stress on the trees' anchorage in windy conditions, it may also prevent a comprehensive tree inspection and should therefore be removed annually whilst the ivy is small and accessible.

It is not known whether the trees on site are subject to any Tree Preservation Orders or Conservation Orders, and you should check with your local planning authority that necessary permissions are in place prior to commencing any maintenance work on the trees.

Trees of Note:

None

2. TREE WORKS



TREE NUMBERS	
URGENT	0
PRIORITY 1	0
PRIORITY 2	3
ROUTINE	0

Urgent Works – There are currently no urgent works to be undertaken.

Priority 1 – Remedial Health and Safety works to be completed within 3 months of report.

Priority 2 – Remedial Health and Safety works to be completed within 1 year of report.

Routine – Routine works to be completed within 3 years or as part of your regular grounds' maintenance.

The priority ratings provide an indication of how quickly recommended works should be carried out. Where you have a number of large, mature trees on site and increased costs, you may wish to prioritise those trees located within high impact areas.

NB. Quotes for recommended works can be obtained from LCC contractors upon request.

3. KEY RECOMMENDATIONS

- A full list of detailed tree management work recommendations is identified in the schedule and should be carried out as the priority states.

4. APPENDICIES

I) TREE SURVEYS

- The survey has included a close visual inspection of the external features of all significant trees on the site.
- The trees were inspected from ground level with no climbing inspections undertaken. No samples have been removed from the site for analysis.
- It should be noted that it is a criminal offence to disturb or destroy – whether intentional or unintentional - the nesting sites of wild birds or the roost sites of bats, under the 'Wildlife & Countryside Act 1981 and the 'Countryside and Rights of Way Act 2000'. It is not permitted to carry out significant tree works if active bird nests or bat roosts are present, and trees must be professionally surveyed for signs of bat roosts and/or bat activity before any tree works commence.

RE-INSPECTION PROCEDURE

It is important that trees are regularly inspected to monitor condition and identify any necessary remedial works. It is recommended that the following reinspection schedule should apply:

- **High Risk Trees**- re-inspections will take place every 18 months.
- **Moderate Risk Trees** - re-inspections every three years
- **Low Risk Trees** - re-inspections every six years

All trees should be included in formal routine (i.e., annual) risk assessments carried out by a suitably competent member of the site staff – an additional risk assessment should always be undertaken immediately following severe weather events i.e., high winds, heavy rain or snow falls. If in doubt regarding the safety of a particular tree, please contact the County Council's Forestry Group.

TREE WORKS

- All tree works should be carried out in line with British Standard 3998:2010 – “British Standard Recommendations for Tree Works”.
- Stump chipping will only be included for stumps of felled trees where these are considered to be a hazard. (e.g., adjacent to thoroughfares). You may, however, wish to consider removing other stumps on the site if you are concerned that they may be an obstruction or potential hazard.
- Should you choose to make your own arrangements, all works should be carried out by a competent, suitably qualified and appropriately insured arboricultural contractor in accordance with the British Standard. You should have regard to your ‘duty of care’ under the Health and Safety at Work Act 1974 when directly employing tree-work contractors, and your potential liability if damage or injury occurs because of poor practices.
- If the trees proposed for work are included in any statutory protection (e.g., tree preservation orders) no intervention should take place until written permission has been obtained from the relevant authority.
- The trees inspected and detailed within this report have been selected for inclusion due to their influence on the site. Where works have been recommended to trees outside the ownership of the site, these can only progress with the agreement of the owner, except where it involves parts of the trees overhanging the boundary.

LIMITATIONS

Tree inspection reports are subject to the following limitations:

- Given the dynamic nature of trees and their environment, the condition of the trees could alter at any time. All trees should be inspected by the owners on an annual basis and any recorded findings of concerns be reported to the County Council’s Forestry Group.
- Where trees are visually obscured (e.g., ivy) they should be made visible before a full visual inspection can take place. Any limitations of the assessment will be highlighted in the report.
- The validity, accuracy and findings of this report will be directly related to the accuracy of the information made available prior to and during its production. Leicestershire County Council will not be responsible for the recommendations within this report where essential data is not made available or is inaccurate.
- This report is valid as of the date of inspection, and only whilst site conditions remain unaltered. It may become invalid if for example construction works or changes in soil level take place in close proximity to the tree or trees concerned.
- It must also be appreciated that recommendations proposed within this report may be superseded by extreme weather, or any other unreasonably foreseeable events. Trees should be internally inspected after adverse weather conditions and any changes reported to the County Council’s Forestry Group.

If you would like further advice with regard to the survey or would like to arrange for the recommended work to be carried out, please contact Rob Hardingham (rob.hardingham@leics.gov.uk). Records of works to your trees can then be maintained and updated accordingly on our dedicated tree management database.

II) TREE SURGERY AND MAINTENANCE

GLOSSARY OF TERMS

The following terms, which may be included in your tree survey, relate to tree surgery and felling operations as defined in the County Council's forestry and arboricultural specifications and in British Standard 3998:2010 'Recommendations for Tree Work': -

- General Works* – this operation consists of a number of basic maintenance tasks including the removal of suckers, basal growth and dense shoot growth from the trunk of the tree, repair of minor bark wounds, removal of foreign debris, removal of minor branches which obstruct overhead services and access and the severance of climbing plants such as Ivy.
- Crown Lifting* - this operation consists of the removal of lower branches, twigs and dense shoot growth from the trunk of the tree in order to increase the clearance under its canopy.
- Cleaning Out* - the removal of dead, dying, diseased and irreparably damaged branches from throughout the crown of the tree.
- Crown Thinning* - the removal of a proportion of secondary lateral branches from the main branch structure of the tree to achieve an increase in light penetration through the crown and lessen the degree of resistance in windy conditions.
- Crown Reduction* - this operation includes the reduction in the overall height and spread of a tree whilst retaining a natural shape to its crown, typical of the species.
- Formative Pruning* - the selective pruning of the tree in order to promote the development of a well-formed mature specimen of a shape, habit and branch structure typical of the species.
- Further Investigation* - a more detailed and precise analysis of inaccessible areas, internal cavities, compressed forks etc.
- Pollarding* - this operation consists of a substantial reduction in the height and/or spread of a tree's crown to a point from where a new crown may develop. This is often carried out to remove potential weak points and is a method of management which needs to be repeated at regular intervals.
- Straight Felling* - the felling of a whole tree in one operation.
- Sectional Felling* - the felling/dismantling of a tree in sections of a size appropriate to the location so as to avoid damage to surrounding features.

If you require any further clarification of the recommendations detailed in your tree survey, please contact the Forestry Group on 0116 3056920.

Tree Code	Seq No	Common Name	what3words	Height(m)	Spread(m (d))	Age Class	Conditions	Recommendations	Priority
Site: Hermitage Road Play Area 010									
Location: Whitwick, NWL									
13744	1	Norway Maple	///soap.puzzle.unless	15	14	Mature	<ul style="list-style-type: none"> Fair Trunk - Epicormics/suckers Trunk - Partially occluded wound Roots - Mower damage on exposed roots 	None Recorded..	No action required
13888	G1	Mixed Broadleaves	///ballots.frog.cherry	12	7	Young-Mature	<ul style="list-style-type: none"> Fair 	None Recorded..	No action required
13893	G2	Cherry Plum	///puts.wipe.hatch	6	4	Mature	<ul style="list-style-type: none"> Fair Trunk - Multi-stemmed 	<ul style="list-style-type: none"> Straight Fell - fell paint spotted trees (x 3 tree) 	Priority 2
13878	2	Hawthorn	///silly.pump.lawn	6	8	Mature	<ul style="list-style-type: none"> Fair Crown - Minor Deadwood < 100mm Crown - Low Branches Crown - Poor pruning/old stubs Trunk - Multi-stemmed 	None Recorded..	No action required
13749	3	Apple spp	///indoor.firm.help	7	7	Mature	<ul style="list-style-type: none"> Fair Crown - Minor Deadwood < 100mm Trunk - Minor Trunk Decay Trunk - Partially occluded wound Trunk - Fully occluded wound 	None Recorded..	No action required
13753	G3	Mixed Broadleaves	///lives.ticket.shut	12	8	Young-Mature	<ul style="list-style-type: none"> Fair Crown - Fungus - Hymenoscyphus (Ash Dieback) 	<ul style="list-style-type: none"> Section Fell - fell paint marked Ash towards bottom corner (x 1 tree) 	Priority 2
13883	4	Wild Cherry	///counts.steep.update	13	8	Young-Mature	<ul style="list-style-type: none"> Fair Crown - Minor Deadwood < 100mm 	None Recorded..	No action required
13754	5	Wild Cherry	///first.stroke.placed	14	9	Young-Mature	<ul style="list-style-type: none"> Poor FELLED Crown - Minor Deadwood < 100mm Trunk - Forked Trunk Trunk - Included Bark Trunk - Weak Unions 	None Recorded..	No action required
13759	6	Goat Willow	///luck.deeply.reds	14	9	Young-Mature	<ul style="list-style-type: none"> Fair Crown - Minor Deadwood < 100mm Trunk - Forked Trunk Trunk - Minor Trunk Decay Trunk - Partially occluded wound 	None Recorded..	No action required

Tree Code	Seq No	Common Name	what3words	Height(m)	Spread(m (d))	Age Class	Conditions	Recommendations	Priority
Site: Hermitage Road Play Area 010									
Location: Whitwick, NWL									
13764	7	Common Ash	///noon.grace.fakes	15	9	Young-Mature	<ul style="list-style-type: none"> · Poor · Crown - Major Deadwood >100mm · Crown - Minor Branch Dieback · Crown - Branch Decay · Crown - Branch wounds 	<ul style="list-style-type: none"> · Section Fell 	Priority 2
13769	8	Sycamore	///into.grows.precautions	15	11	Young-Mature	<ul style="list-style-type: none"> · Fair · Crown - Minor Deadwood < 100mm · Trunk - Multi-stemmed 	<ul style="list-style-type: none"> · None Recorded.. 	No action required
13774	9	Common Ash	///noon.grace.fakes	13	9	Young-Mature	<ul style="list-style-type: none"> · Fair · Crown - Minor Deadwood < 100mm 	<ul style="list-style-type: none"> · None Recorded.. 	No action required
13779	10	Common Ash	///ballots.frog.cherry	15	9	Young-Mature	<ul style="list-style-type: none"> · Fair · Crown - Minor Deadwood < 100mm 	<ul style="list-style-type: none"> · None Recorded.. 	No action required
13784	11	Wild Cherry	///belt.mirror.takes	15	9	Young-Mature	<ul style="list-style-type: none"> · Fair · Crown - Minor Deadwood < 100mm 	<ul style="list-style-type: none"> · None Recorded.. 	No action required
13789	12	Sycamore	///analogy.orange.noting	15	11	Middle-Aged	<ul style="list-style-type: none"> · Good 	<ul style="list-style-type: none"> · None Recorded.. 	No action required
13794	13	Cherry Plum	///melt.march.pirate	11	11	Mature	<ul style="list-style-type: none"> · Fair · Crown - Low Branches · Crown - Previous crown lift · Crown - Poor pruning/old stubs 	<ul style="list-style-type: none"> · None Recorded.. 	No action required
13898	14	Common Pear	///transit.penny.eagles	11	9	Over-Mature	<ul style="list-style-type: none"> · Poor · FELLED · Crown - Minor Deadwood < 100mm · Trunk - Major Trunk Decay 	<ul style="list-style-type: none"> · None Recorded.. 	No action required
13903	15	Common Pear	///hurry.rapid.hungry	11	9	Over-Mature	<ul style="list-style-type: none"> · Poor · FELLED · Crown - Minor Deadwood < 100mm · Trunk - Major Trunk Decay 	<ul style="list-style-type: none"> · None Recorded.. 	No action required
13799	16	Wild Cherry	///formed.bank.level	16	14	Over-Mature	<ul style="list-style-type: none"> · Poor · FELLED · Trunk - Forked Trunk · Trunk - Included Bark · Trunk - Major Trunk Decay · Trunk - Trunk Cavity · Trunk - Crack/split 	<ul style="list-style-type: none"> · None Recorded.. 	No action required
13908	17	Field Maple	///riding.heads.fine	13	10	Young-Mature	<ul style="list-style-type: none"> · Fair · Crown - Minor Deadwood < 100mm · Trunk - Epicormics/suckers · Trunk - Forked Trunk · Trunk - Weak Unions 	<ul style="list-style-type: none"> · None Recorded.. 	No action required

Tree Code	Seq No	Common Name	what3words	Height(m)	Spread(m (d))	Age Class	Conditions	Recommendations	Priority
Site: Hermitage Road Play Area 010									
Location: Whitwick, NWL									
13913	18	Common Ash	///heat.noting.treat	15	11	Young-Mature	<ul style="list-style-type: none"> · Fair · Crown - Minor Deadwood < 100mm · Trunk - Forked Trunk 	None Recorded..	No action required
13746	19	Wild Cherry	///orders.notion.guard	15	11	Young-Mature	<ul style="list-style-type: none"> · Fair · FELLED · Crown - Minor Deadwood < 100mm · Crown - Crossing Branches · Trunk - Forked Trunk 	None Recorded..	No action required
13918	20	Silver Birch	///glitz.sports.pulse	17	13	Middle-Aged	<ul style="list-style-type: none"> · Poor · FELLED · Crown - Minor Deadwood < 100mm · Crown - Minor Branch Dieback · Crown - Broken Hanging Branches · Trunk - Forked Trunk 	None Recorded..	No action required
13748	21	Common Ash	///pens.bubble.stick	15	12	Young-Mature	<ul style="list-style-type: none"> · Fair · Crown - Minor Deadwood < 100mm · Crown - Low Branches 	None Recorded..	No action required
13751	22	Field Maple	///sunk.manual.veal	7	6	Young-Mature	<ul style="list-style-type: none"> · Fair · Crown - Minor Deadwood < 100mm · Trunk - Forked Trunk 	None Recorded..	No action required
Overall Total:									132 trees

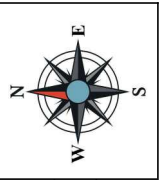
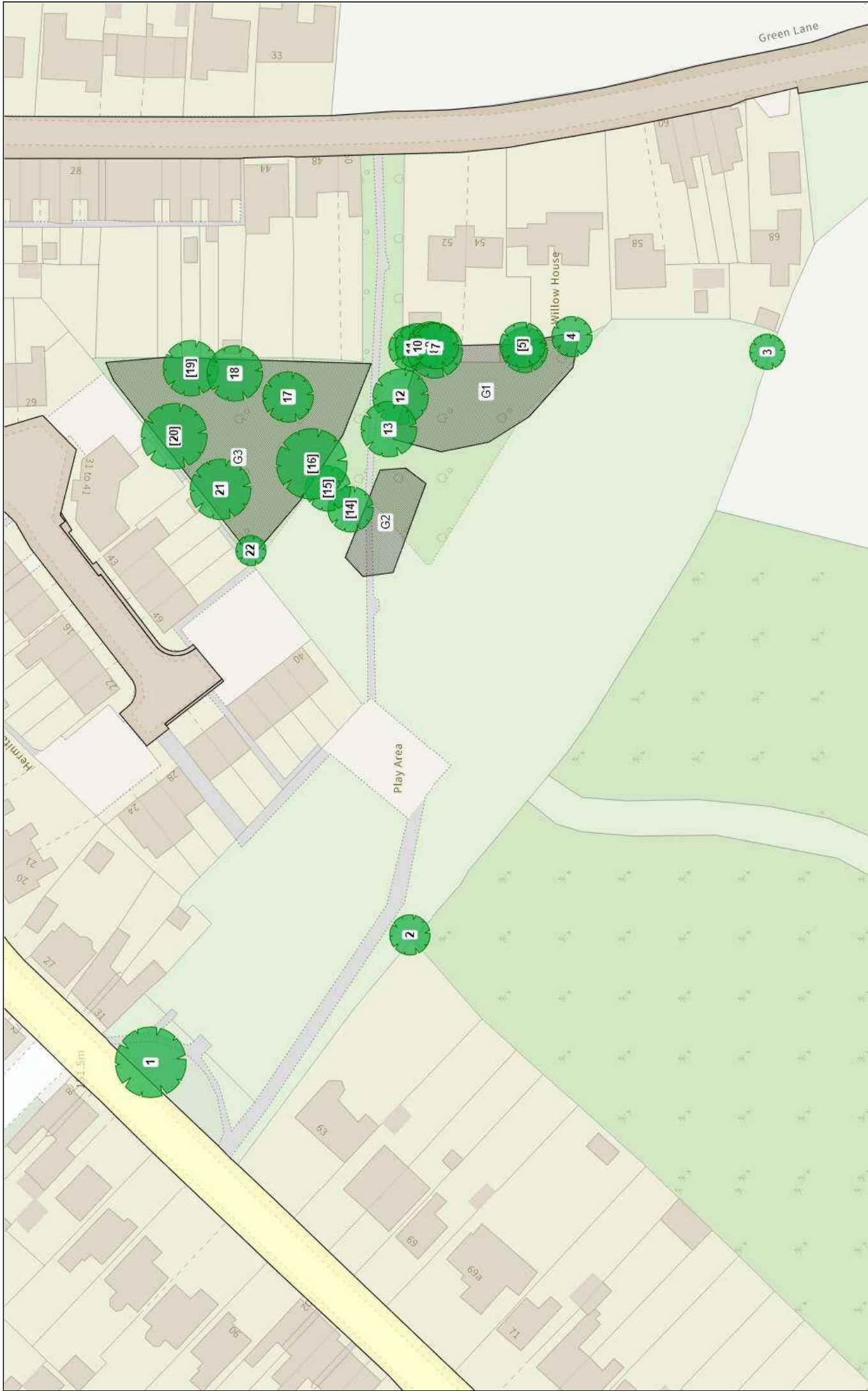

Scale	1:454
Date	09/04/2026

Overview



Reproduced from the Ordnance Survey mapping with the permission of the Controller of Her Majesty's Stationery Office. © Crown Copyright Reserved. Unauthorised reproduction infringes Crown Copyright and may lead to prosecution or civil proceedings.

Tree Code	Seq No	Common Name	what3words	Height(m)	Spread(m (dl))	Age Class	Features	Conditions	Recommendations	Priority
-----------	--------	-------------	------------	-----------	----------------	-----------	----------	------------	-----------------	----------

Location: Whitwick, NWL

Site: Hermitage Road Play Area 010

13893	G2	Cherry Plum	///puts.wipe.hatch	6	4	Mature	None Recorded..	· Fair · Trunk - Multi-stemmed	· Straight Fell - fell paint spotted trees (x 3 tree)	Priority 2
13753	G3	Mixed Broadleave s	///lives.ticket.shut	12	8	Young-Mature	· Adjacent - Parking area · Adjacent - Private garden	· Fair · Crown - Fungus - Hymenocyphus (Ash Dieback)	· Section Fell - fell paint marked Ash towards bottom corner (x 1 tree)	Priority 2
13764	7	Common Ash	///noon.grace.fakes	15	9	Young-Mature	· Hazards - Adj. Building - within 3m	· Poor · Crown - Major Deadwood >100mm · Crown - Minor Branch Dieback · Crown - Branch Decay · Crown - Branch wounds	· Section Fell	Priority 2

Overall Total: 71 trees

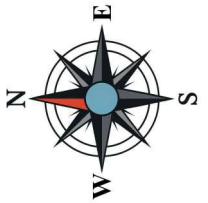
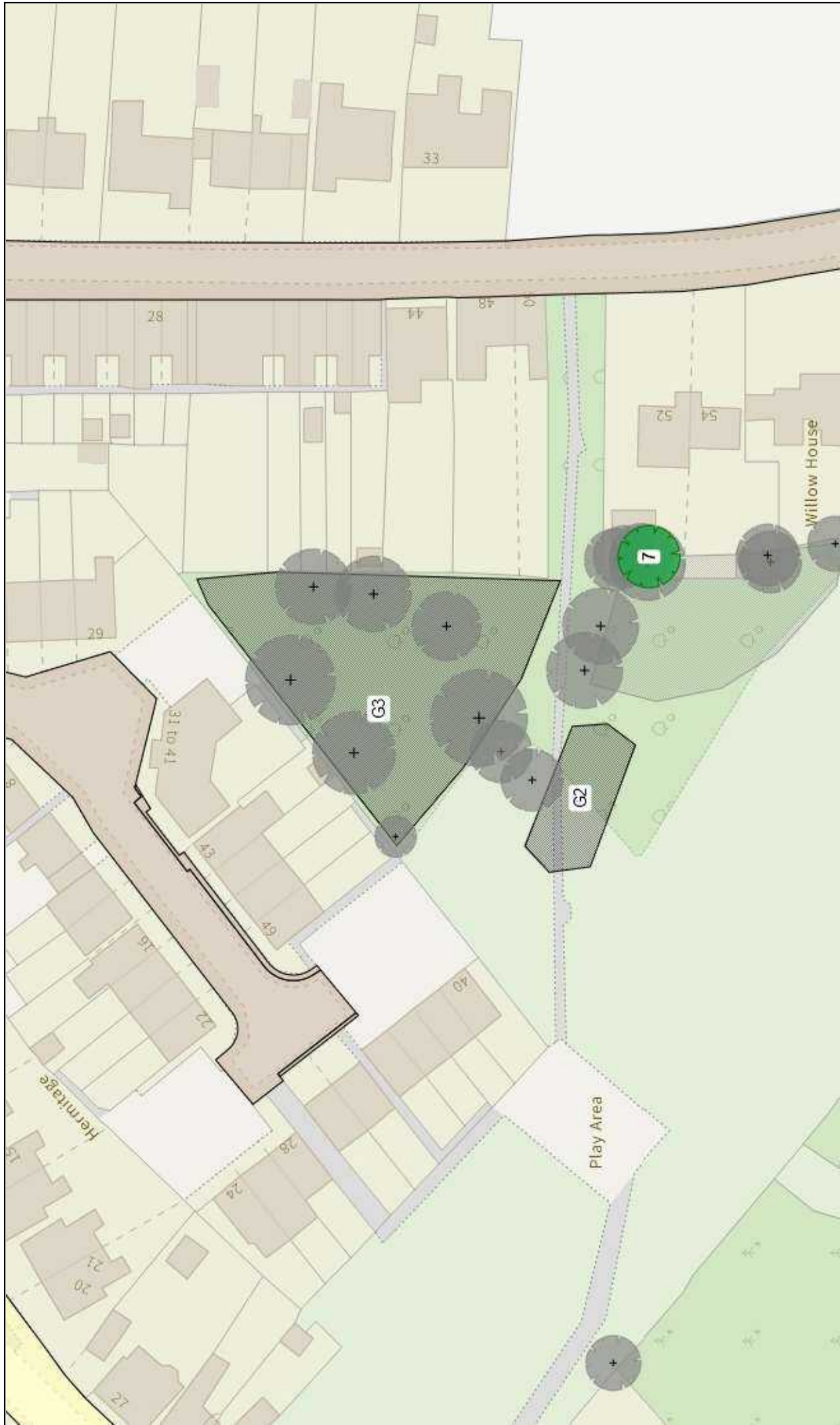

Scale	1: 547
Date	09/04/2026

Overview

Reproduced from the Ordnance Survey mapping with the permission of the Controller of Her Majesty's Stationery Office. (c) Crown Copyright Reserved. Unauthorised reproduction infringes Crown Copyright and may lead to prosecution or civil proceedings.



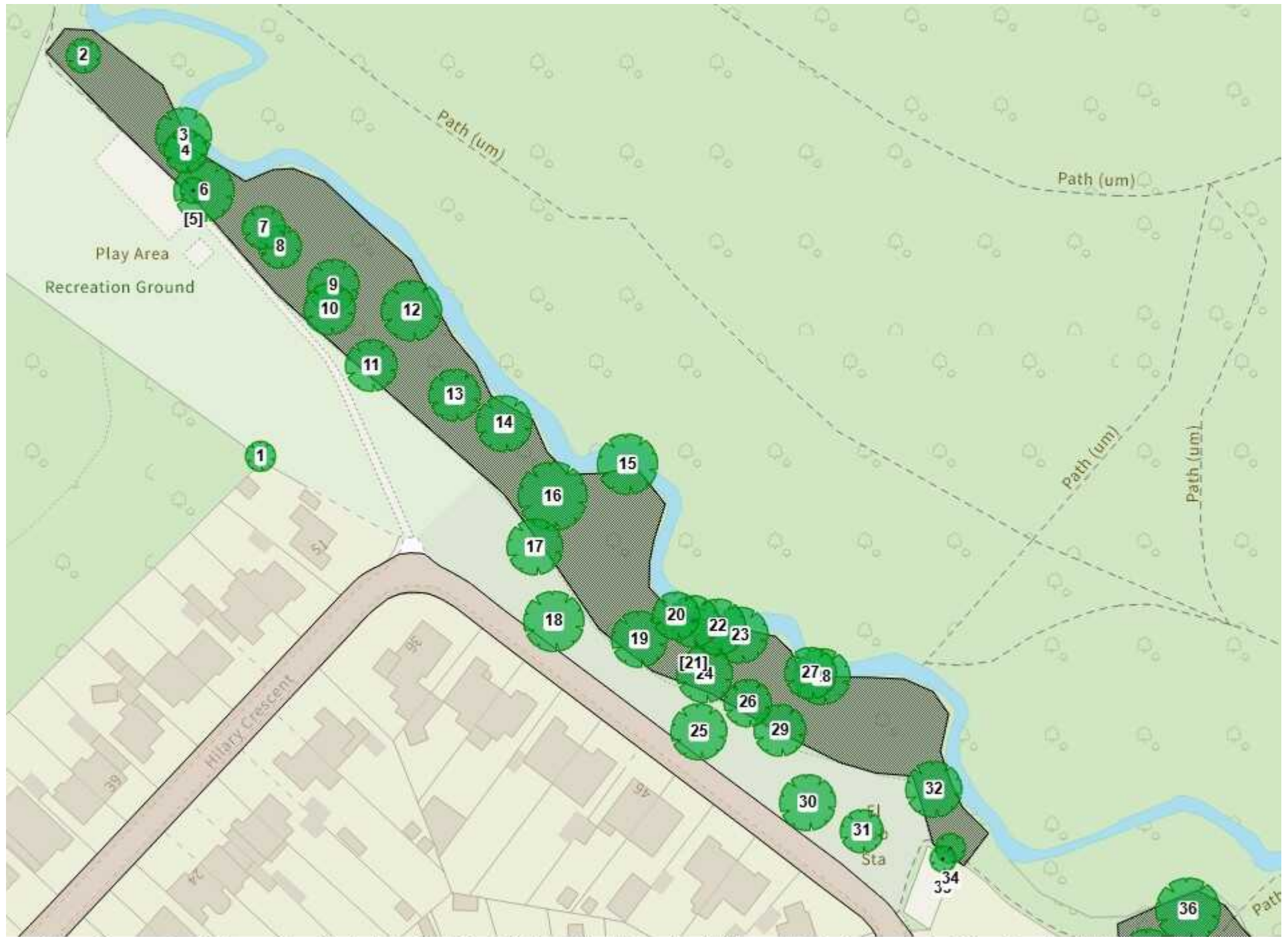



FORESTRY AND ARBORICULTURAL GROUP TREE REPORT

Hilary Crescent Open Space

Whitwick

28th April 2026

SURVEYOR: Rob Hardingham



CONTENTS

- 1 General Tree Statement
- 2 Tree Works
- 3 Recommendations
- 4 Appendices

Included separately to this report.

- Tree survey schedule
- Site Maps

PURPOSE

This report has been prepared for Hilary Crescent Open Space as part of the tree safety survey conducted on 15th April 2026. It includes fifty-three individual trees, and five tree groups spread over the site.

Details for the individual trees may be found in the separate accompanying schedule.

SURVEY METHODOLOGY

The survey has been conducted from ground level and has included a close visual inspection of the external features of all significant trees on the site. The trees are plotted and numbered on the enclosed plans and details of each individual tree are given on the survey schedule attached.

Where an identified defect represents a potential hazard to users of the site, recommendations for remedial tree work have been detailed against individual trees. These works have been prioritised into the categories specified below and are detailed within the attached schedule.

FINDINGS

Recommendations for remedial works have been made in the survey under Priority 1, Priority 2 and Routine works. These trees have been identified as requiring attention at the time of the survey. You are advised to take the necessary steps to arrange for the recommended work to be completed.

'High Risk' trees are large trees close to busy areas with one or more significant defects that potentially threaten the structural integrity of the tree. These trees may be required to be re-inspected every 18 months. Any trees in this category will be highlighted in the report. All trees on this site (unless otherwise stated) should be considered as 'Moderate Risk' due to the open public aspect of the site and re-inspected every 3 years.

Routine works are those that may be picked up as part of your routine ground's maintenance cycle over three years. In some cases, these may be works that could be carried out by your own ground staff at no additional cost.

All trees should be kept routinely clear of ivy so that any evidence of poor health or safety concerns can be identified. Where trees have not been inspected due to excessive ivy, it is possible that they may not be covered by your insurance in the event of an incident. They should therefore be cleared and booked in for re-inspection as soon as possible.

1. GENERAL TREE STATEMENT

Fifty-three individual trees and five tree groups were surveyed and were generally found to be in good health for their age, species and context. There are a number of mature trees on site which exhibit a range of characteristics commensurate with their age and maturity.

Works have been recommended to four trees and two tree groups on the site. Some trees would benefit from the removal of excessive ivy which increases the risk of failure due to excess weight on weak limbs and places excessive stress on the trees' anchorage in windy conditions, it may also prevent a comprehensive tree inspection and should therefore be removed annually whilst the ivy is small and accessible.

It is not known whether the trees on site are subject to any Tree Preservation Orders or Conservation Orders, and you should check with your local planning authority that necessary permissions are in place prior to commencing any maintenance work on the trees.

Trees of Note:

I have made recommendations for G1 to fell/cut up a fallen Poplar, this tree has fallen from the adjacent land across the stream into your ownership, you may wish to contact the adjacent landowner and ask them to undertake the works.

2. TREE WORKS

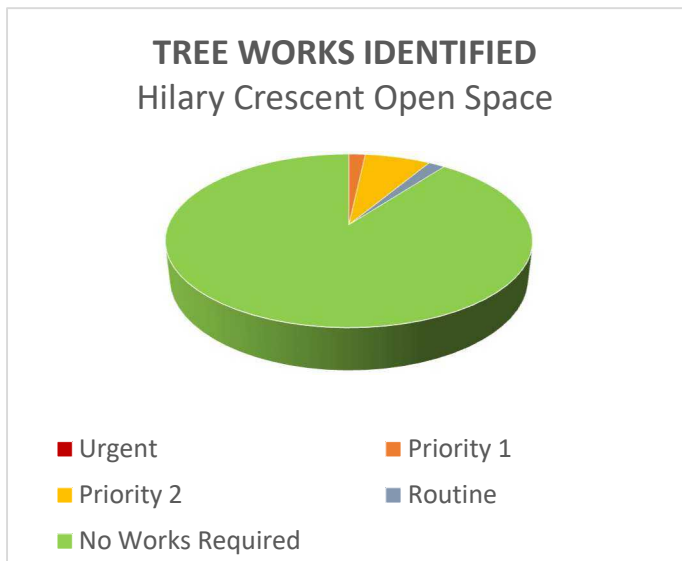

TREE NUMBERS	
URGENT	0
PRIORITY 1	1
PRIORITY 2	4
ROUTINE	1

Urgent Works – There are currently no urgent works to be undertaken.

Priority 1 – Remedial Health and Safety works to be completed within 3 months of report.

Priority 2 – Remedial Health and Safety works to be completed within 1 year of report.

Routine – Routine works to be completed within 3 years or as part of your regular grounds' maintenance.

The priority ratings provide an indication of how quickly recommended works should be carried out. Where you have a number of large, mature trees on site and increased costs, you may wish to prioritise those trees located within high impact areas.

NB. Quotes for recommended works can be obtained from LCC contractors upon request.

3. KEY RECOMMENDATIONS

- A full list of detailed tree management work recommendations is identified in the schedule and should be carried out as the priority states.

4. APPENDICIES

I) TREE SURVEYS

- The survey has included a close visual inspection of the external features of all significant trees on the site.
- The trees were inspected from ground level with no climbing inspections undertaken. No samples have been removed from the site for analysis.
- It should be noted that it is a criminal offence to disturb or destroy – whether intentional or unintentional - the nesting sites of wild birds or the roost sites of bats, under the 'Wildlife & Countryside Act 1981 and the 'Countryside and Rights of Way Act 2000'. It is not permitted to carry out significant tree works if active bird nests or bat roosts are present, and trees must be professionally surveyed for signs of bat roosts and/or bat activity before any tree works commence.

RE-INSPECTION PROCEDURE

It is important that trees are regularly inspected to monitor condition and identify any necessary remedial works. It is recommended that the following reinspection schedule should apply:

- **High Risk Trees**- re-inspections will take place every 18 months.
- **Moderate Risk Trees** - re-inspections every three years
- **Low Risk Trees** - re-inspections every six years

All trees should be included in formal routine (i.e., annual) risk assessments carried out by a suitably competent member of the site staff – an additional risk assessment should always be undertaken immediately following severe weather events i.e., high winds, heavy rain or snow falls. If in doubt regarding the safety of a particular tree, please contact the County Council's Forestry Group.

TREE WORKS

- All tree works should be carried out in line with British Standard 3998:2010 – “British Standard Recommendations for Tree Works”.
- Stump chipping will only be included for stumps of felled trees where these are considered to be a hazard. (e.g., adjacent to thoroughfares). You may, however, wish to consider removing other stumps on the site if you are concerned that they may be an obstruction or potential hazard.
- Should you choose to make your own arrangements, all works should be carried out by a competent, suitably qualified and appropriately insured arboricultural contractor in accordance with the British Standard. You should have regard to your ‘duty of care’ under the Health and Safety at Work Act 1974 when directly employing tree-work contractors, and your potential liability if damage or injury occurs because of poor practices.
- If the trees proposed for work are included in any statutory protection (e.g., tree preservation orders) no intervention should take place until written permission has been obtained from the relevant authority.
- The trees inspected and detailed within this report have been selected for inclusion due to their influence on the site. Where works have been recommended to trees outside the ownership of the site, these can only progress with the agreement of the owner, except where it involves parts of the trees overhanging the boundary.

LIMITATIONS

Tree inspection reports are subject to the following limitations:

- Given the dynamic nature of trees and their environment, the condition of the trees could alter at any time. All trees should be inspected by the owners on an annual basis and any recorded findings of concerns be reported to the County Council’s Forestry Group.
- Where trees are visually obscured (e.g., ivy) they should be made visible before a full visual inspection can take place. Any limitations of the assessment will be highlighted in the report.
- The validity, accuracy and findings of this report will be directly related to the accuracy of the information made available prior to and during its production. Leicestershire County Council will not be responsible for the recommendations within this report where essential data is not made available or is inaccurate.
- This report is valid as of the date of inspection, and only whilst site conditions remain unaltered. It may become invalid if for example construction works or changes in soil level take place in close proximity to the tree or trees concerned.
- It must also be appreciated that recommendations proposed within this report may be superseded by extreme weather, or any other unreasonably foreseeable events. Trees should be internally inspected after adverse weather conditions and any changes reported to the County Council’s Forestry Group.

If you would like further advice with regard to the survey or would like to arrange for the recommended work to be carried out, please contact Rob Hardingham (rob.hardingham@leics.gov.uk). Records of works to your trees can then be maintained and updated accordingly on our dedicated tree management database.

II) TREE SURGERY AND MAINTENANCE

GLOSSARY OF TERMS

The following terms, which may be included in your tree survey, relate to tree surgery and felling operations as defined in the County Council's forestry and arboricultural specifications and in British Standard 3998:2010 'Recommendations for Tree Work': -

- General Works* – this operation consists of a number of basic maintenance tasks including the removal of suckers, basal growth and dense shoot growth from the trunk of the tree, repair of minor bark wounds, removal of foreign debris, removal of minor branches which obstruct overhead services and access and the severance of climbing plants such as Ivy.
- Crown Lifting* - this operation consists of the removal of lower branches, twigs and dense shoot growth from the trunk of the tree in order to increase the clearance under its canopy.
- Cleaning Out* - the removal of dead, dying, diseased and irreparably damaged branches from throughout the crown of the tree.
- Crown Thinning* - the removal of a proportion of secondary lateral branches from the main branch structure of the tree to achieve an increase in light penetration through the crown and lessen the degree of resistance in windy conditions.
- Crown Reduction* - this operation includes the reduction in the overall height and spread of a tree whilst retaining a natural shape to its crown, typical of the species.
- Formative Pruning* - the selective pruning of the tree in order to promote the development of a well-formed mature specimen of a shape, habit and branch structure typical of the species.
- Further Investigation* - a more detailed and precise analysis of inaccessible areas, internal cavities, compressed forks etc.
- Pollarding* - this operation consists of a substantial reduction in the height and/or spread of a tree's crown to a point from where a new crown may develop. This is often carried out to remove potential weak points and is a method of management which needs to be repeated at regular intervals.
- Straight Felling* - the felling of a whole tree in one operation.
- Sectional Felling* - the felling/dismantling of a tree in sections of a size appropriate to the location so as to avoid damage to surrounding features.

If you require any further clarification of the recommendations detailed in your tree survey, please contact the Forestry Group on 0116 3056920.

Tree Code	Seq No	Common Name	what3words	Height(m)	Spread(m (d))	Age Class	Conditions	Recommendations	Priority
Site: Hilary Crescent Open Space 012									
Location: Whitwick, NWL									
14354	1	Hawthorn	///afford.clock.blur	7	7	Mature	<ul style="list-style-type: none"> Fair Crown - Minor Deadwood < 100mm Trunk - Multi-stemmed Trunk - Ivy/Climber 	None Recorded..	No action required
14526	G1	Mixed Broadleaves	///lined.dogs.remark	0	0	Mature	<ul style="list-style-type: none"> Fair 	<ul style="list-style-type: none"> Straight Fell - clear 2x fallen stems at North West end of group adjacent gated access and fallen Poplar roughly opposite 52 fallen across stream (x 2 tree) 	Priority 2
14531	G2	Mixed Broadleaves	///edges.fine.saving	15	10	Middle-Aged	<ul style="list-style-type: none"> Fair Trunk - Ivy/Climber 	<ul style="list-style-type: none"> Section Fell - fell 2x Ash to rear of 39 Petersfels paint marked (x 2 tree) 	Priority 2
14359	2	Hawthorn	///blaze.guilty.agent	9	8	Mature	<ul style="list-style-type: none"> Fair Crown - Minor Deadwood < 100mm Trunk - Multi-stemmed Trunk - Ivy/Climber Trunk - Minor Trunk Decay 	None Recorded..	No action required
14364	3	Common Ash	///degree.rank.badge	19	13	Mature	<ul style="list-style-type: none"> Fair Crown - Minor Deadwood < 100mm Crown - Broken Hanging Branches Trunk - Ivy/Climber Trunk - Minor Trunk Decay 	None Recorded..	No action required
14491	G3	Mixed Broadleaves	///loads.hang.mercy	8	5	Young-Mature	<ul style="list-style-type: none"> Fair Crown - Minor Deadwood < 100mm Crown - Low Branches 	None Recorded..	No action required
14496	G4	Mixed Broadleaves	///sculpture.cans.rather	9	5	Young-Mature	<ul style="list-style-type: none"> Fair Crown - Minor Deadwood < 100mm Crown - Low Branches 	None Recorded..	No action required
14369	4	English Oak	///raced.term.urban	14	10	Young-Mature	<ul style="list-style-type: none"> Fair Crown - Minor Deadwood < 100mm Trunk - Ivy/Climber 	None Recorded..	No action required
14374	5	Wych Elm	///brain.gear.expand	10	6	Middle-Aged	<ul style="list-style-type: none"> Dead FELLED Trunk - Ivy/Climber 	None Recorded..	No action required
14566	G5	Mixed Broadleaves	///camps.planet.trip	12	8	Young-Mature	<ul style="list-style-type: none"> Fair Trunk - Ivy/Climber 	None Recorded..	No action required
14379	6	Common Ash	///tamed.crush.ritual	19	14	Mature	<ul style="list-style-type: none"> Fair Crown - Minor Deadwood < 100mm Crown - Tearout wound Trunk - Ivy/Climber Trunk - Forked Trunk 	<ul style="list-style-type: none"> General Works Cut Ivy (No Price) 	Routine

Tree Code	Seq No	Common Name	what3words	Height(m)	Spread(m (d))	Age Class	Conditions	Recommendations	Priority
Site: Hilary Crescent Open Space 012									
Location: Whitwick, NWL									
14406	7	English Oak	///chained.stick.pushy	14	10	Young-Mature	<ul style="list-style-type: none"> · Fair · Crown - Minor Deadwood < 100mm · Trunk - Ivy/Climber · Trunk - Forked Trunk 	None Recorded..	No action required
14411	8	English Oak	///they.always.chain	14	10	Young-Mature	<ul style="list-style-type: none"> · Fair · Crown - Minor Deadwood < 100mm · Crown - Low Branches 	None Recorded..	No action required
14384	9	English Oak	///burns.crowned.kind	15	12	Young-Mature	<ul style="list-style-type: none"> · Fair · Crown - Minor Deadwood < 100mm · Trunk - Multi-stemmed · Trunk - Ivy/Climber 	None Recorded..	No action required
14389	10	Sycamore	///crops.feed.fine	15	12	Young-Mature	<ul style="list-style-type: none"> · Fair · Crown - Minor Deadwood < 100mm · Crown - Squirrel Damage · Trunk - Multi-stemmed · Trunk - Ivy/Climber 	None Recorded..	No action required
14394	11	Sycamore	///mimic.trout.leap	15	12	Young-Mature	<ul style="list-style-type: none"> · Fair · Crown - Minor Deadwood < 100mm · Crown - Squirrel Damage · Trunk - Ivy/Climber 	None Recorded..	No action required
14399	12	Common Alder	///chase.windy.thick	19	14	Mature	<ul style="list-style-type: none"> · Fair · Crown - Minor Deadwood < 100mm · Trunk - Multi-stemmed · Trunk - Included Bark 	None Recorded..	No action required
14416	13	English Oak	///sits.boots.foster	17	12	Young-Mature	<ul style="list-style-type: none"> · Fair · Crown - Minor Deadwood < 100mm · Trunk - Forked Trunk · Trunk - Included Bark · Trunk - Weak Unions - starting to join 	None Recorded..	No action required
14377	14	Common Alder	///frank.types.public	18	13	Mature	<ul style="list-style-type: none"> · Fair · Crown - Minor Deadwood < 100mm · Trunk - Multi-stemmed · Trunk - Ivy/Climber 	None Recorded..	No action required
14421	15	English Oak	///fumes.such.held	18	14	Mature	<ul style="list-style-type: none"> · Fair · Crown - Major Deadwood >100mm · Trunk - Ivy/Climber · Trunk - Minor Trunk Decay 	None Recorded..	No action required
14426	16	English Oak	///claps.clues.ripe	19	16	Mature	<ul style="list-style-type: none"> · Good · Trunk - Ivy/Climber · Trunk - Forked Trunk 	None Recorded..	No action required

Tree Code	Seq No	Common Name	what3words	Height(m)	Spread(m (d))	Age Class	Conditions	Recommendations	Priority
Site: Hilary Crescent Open Space 012									
Location: Whitwick, NWL									
14381	17	Sycamore	///plant.froth.honey	16	13	Mature	<ul style="list-style-type: none"> · Fair · Crown - Previous crown reduction - For power lines · Crown - Branch wounds · Crown - Squirrel Damage · Trunk - Forked Trunk 	None Recorded..	No action required
14382	18	Sycamore	///parts.broker.tests	17	14	Mature	<ul style="list-style-type: none"> · Fair · Crown - Previous crown reduction - For power lines · Trunk - Epicomics/suckers · Trunk - Forked Trunk · Trunk - Included Bark · Roots - Mower damage on exposed roots 	None Recorded..	No action required
14431	19	Common Ash	///cage.raft.jabs	17	13	Mature	<ul style="list-style-type: none"> · Fair · Crown - Minor Deadwood < 100mm · Crown - Low Branches · Crown - Previous crown reduction - for power line · Trunk - Ivy/Climber · Trunk - Forked Trunk 	None Recorded..	No action required
14383	20	Common Alder	///stow.hammer.transit	13	11	Mature	<ul style="list-style-type: none"> · Fair · Crown - Minor Deadwood < 100mm · Trunk - Epicomics/suckers · Trunk - Ivy/Climber · Trunk - Minor Trunk Decay · Trunk - Trunk Cavity 	None Recorded..	No action required
14436	21	Common Alder	///even.piper.wisely	17	12	Mature	<ul style="list-style-type: none"> · Dead · FELLED · Trunk - Epicomics/suckers · Trunk - Ivy/Climber 	None Recorded..	No action required
14441	22	Common Ash	///even.swung.castle	19	13	Mature	<ul style="list-style-type: none"> · Fair · Crown - Minor Deadwood < 100mm · Crown - Ivy/climber · Trunk - Ivy/Climber 	None Recorded..	No action required
14446	23	Common Ash	///eaten.train.bowls	19	13	Mature	<ul style="list-style-type: none"> · Fair · Crown - Minor Deadwood < 100mm · Trunk - Epicomics/suckers · Trunk - Ivy/Climber 	None Recorded..	No action required

Tree Code	Seq No	Common Name	what3words	Height(m)	Spread(m (d))	Age Class	Conditions	Recommendations	Priority
Site: Hilary Crescent Open Space 012									
Location: Whitwick, NWL									
14451	24	Common Ash	///switch.pages.jeeeps	17	13	Mature	<ul style="list-style-type: none"> · Fair · Crown - Minor Deadwood < 100mm · Crown - Previous crown reduction - For power lines · Crown - Poor pruning/old stubs · Trunk - Ivy/Climber · Trunk - Forked Trunk 	None Recorded..	No action required
14386	25	Norway Maple	///orders.shelf.stop	15	13	Middle-Aged	<ul style="list-style-type: none"> · Fair · Crown - Previous crown reduction - For power lines · Trunk - Forked Trunk · Trunk - Other Defect - nail in trunk about 1m from ground level 	None Recorded..	No action required
14387	26	Norway Maple	///bottle.economies.patio	13	11	Middle-Aged	<ul style="list-style-type: none"> · Fair · Badly-pruned · Crown - Previous crown reduction - For power lines · Trunk - Multi-stemmed 	None Recorded..	No action required
14391	27	Common Alder	///magma.pink.wakes	18	12	Mature	<ul style="list-style-type: none"> · Fair · Crown - Minor Deadwood < 100mm · Trunk - Multi-stemmed · Trunk - Epicomics/suckers · Trunk - Ivy/Climber 	None Recorded..	No action required
14392	28	Common Ash	///bucket.police.baika	18	13	Mature	<ul style="list-style-type: none"> · Fair · Crown - Minor Deadwood < 100mm · Trunk - Ivy/Climber · Trunk - Forked Trunk 	None Recorded..	No action required
14388	29	Sycamore	///bliss.grit.expose	16	12	Middle-Aged	<ul style="list-style-type: none"> · Fair · Badly-pruned · Crown - Previous crown reduction - For power lines · Trunk - Ivy/Climber 	None Recorded..	No action required
14456	30	Norway Maple	///booth.verbs.tunes	15	13	Middle-Aged	<ul style="list-style-type: none"> · Fair · Badly-pruned · Crown - Low Branches · Crown - Previous crown reduction - For power lines 	None Recorded..	No action required
14393	31	Norway Maple	///tunes.props.ideas	14	10	Middle-Aged	<ul style="list-style-type: none"> · Fair · Crown - Previous crown reduction - for power line · Trunk - Minor Trunk Decay · Trunk - Trunk Cavity 	None Recorded..	No action required

Tree Code	Seq No	Common Name	what3words	Height(m)	Spread(m (d))	Age Class	Conditions	Recommendations	Priority
Site: Hilary Crescent Open Space 012									
Location: Whitwick, NWL									
14395	32	Common Ash	///beast.audio.blocks	15	13	Mature	<ul style="list-style-type: none"> · Fair · Crown - Minor Deadwood < 100mm · Crown - Ivy/climber · Trunk - Ivy/Climber · Trunk - Forked Trunk 	None Recorded..	No action required
14396	33	Cherry Plum	///rides.orchestra.pose	7	6	Young-Mature	<ul style="list-style-type: none"> · Fair · Trunk - Ivy/Climber 	None Recorded..	No action required
14397	34	Sycamore	///paths.crunch.both	10	7	Young-Mature	<ul style="list-style-type: none"> · Fair · Crown - Low Branches · Trunk - Ivy/Climber 	None Recorded..	No action required
14398	35	Common Ash	///duke.pitch.answer	17	14	Middle-Aged	<ul style="list-style-type: none"> · Fair · Crown - Broken Hanging Branches · Trunk - Multi-stemmed 	<ul style="list-style-type: none"> · General Works · Clean Out - remove broken branch · Remove Heavy Limb - fell remaining limb with tear out wound paint marked 	Priority 1
14401	36	Common Ash	///swung.pine.forces	17	15	Mature	<ul style="list-style-type: none"> · Fair · Trunk - Ivy/Climber · Trunk - Forked Trunk · Trunk - Weak Unions 	None Recorded..	No action required
14536	37	Sycamore	///limbs.boats.poetic	17	13	Middle-Aged	<ul style="list-style-type: none"> · Fair · Crown - Branch wounds · Trunk - Forked Trunk 	None Recorded..	No action required
14461	38	Sycamore	///cares.ally.brief	17	13	Middle-Aged	<ul style="list-style-type: none"> · Fair · Trunk - Multi-stemmed · Trunk - Epicomics/suckers 	None Recorded..	No action required
14466	39	Sycamore	///clown.tunnel.slips	17	10	Middle-Aged	<ul style="list-style-type: none"> · Poor · Trunk - Major Trunk Decay 	Section Fell	Priority 2
14471	40	Goat Willow	///wires.builds.split	17	10	Middle-Aged	<ul style="list-style-type: none"> · Fair · FELLED · Crown - Minor Deadwood < 100mm · Trunk - Forked Trunk 	None Recorded..	No action required
14541	41	Goat Willow	///reef.camps.liver	15	11	Middle-Aged	<ul style="list-style-type: none"> · Poor · Crown - Major Deadwood >100mm · Crown - Major Branch Dieback · Crown - Crown density 26% to 50% intact · Trunk - Forked Trunk 	Section Fell	Priority 2
14476	42	Rowan	///bonus.cheek.closer	7	6	Over-Mature	<ul style="list-style-type: none"> · Poor · Crown - Minor Deadwood < 100mm · Crown - Minor Branch Dieback · Crown - Previous crown lift · Crown - Branch wounds · Trunk - Forked Trunk 	None Recorded..	No action required

Tree Code	Seq No	Common Name	what3words	Height(m)	Spread(m (d))	Age Class	Conditions	Recommendations	Priority
Site: Hilary Crescent Open Space 012									
Location: Whitwick, NWL									
14481	43	Common Ash	///minds.drum.drop	15	13	Middle-Aged	<ul style="list-style-type: none"> · Fair · Crown - Minor Deadwood < 100mm · Trunk - Ivy/Climber · Trunk - Forked Trunk · Roots - Exposed surface roots 	None Recorded..	No action required
14486	44	Wild Cherry	///spite.return.lungs	15	13	Mature	<ul style="list-style-type: none"> · Fair · Crown - Minor Deadwood < 100mm · Crown - Branch wounds · Trunk - Forked Trunk · Trunk - Fungus - Other - only small dried section remaining unidentifiable 	None Recorded..	No action required
14501	45	Silver Birch	///bath.once.raves	16	14	Mature	<ul style="list-style-type: none"> · Fair · FELLED · Crown - Minor Deadwood < 100mm · Trunk - Minor Trunk Decay · Trunk - Cankers 	None Recorded..	No action required
14506	46	Hawthorn	///clap.vibe.grades	8	6	Mature	<ul style="list-style-type: none"> · Fair · Crown - Minor Deadwood < 100mm · Trunk - Minor Trunk Decay 	None Recorded..	No action required
14546	47	Common Ash	///labels.arrow.cheek	11	7	Young-Mature	<ul style="list-style-type: none"> · Good 	None Recorded..	No action required
14551	48	Sycamore	///vocab.jars.preoccupied	15	12	Young-Mature	<ul style="list-style-type: none"> · Fair · Crown - Minor Deadwood < 100mm · Crown - Previous crown lift · Crown - Poor pruning/old stubs · Trunk - Epicemics/suckers · Trunk - Ivy/Climber 	None Recorded..	No action required
14556	49	Sycamore	///chain.cook.lunch	13	10	Young-Mature	<ul style="list-style-type: none"> · Fair · Crown - Minor Deadwood < 100mm · Trunk - Ivy/Climber · Trunk - Forked Trunk 	None Recorded..	No action required
14561	50	English Oak	///talent.yoga.spike	13	13	Middle-Aged	<ul style="list-style-type: none"> · Fair · Crown - Minor Deadwood < 100mm · Crown - Poor pruning/old stubs · Trunk - Ivy/Climber 	None Recorded..	No action required
14511	51	English Oak	///bliss.rewarding.stand	16	13	Middle-Aged	<ul style="list-style-type: none"> · Fair · Crown - Minor Deadwood < 100mm · Crown - Asymmetric Crown · Trunk - Ivy/Climber 	None Recorded..	No action required

Tree Code	Seq No	Common Name	what3words	Height(m)	Spread(m (d))	Age Class	Conditions	Recommendations	Priority
Site: Hilary Crescent Open Space 012									
Location: Whitwick, NWL									
14516	52	English Oak	///navy.length.unwanted	15	13	Middle-Aged	<ul style="list-style-type: none"> . Fair . Crown - Minor Deadwood < 100mm . Trunk - Ivy/Climber . Trunk - Forked Trunk 	None Recorded..	No action required
14521	53	Goat Willow	///along.sulk.hugs	14	13	Middle-Aged	<ul style="list-style-type: none"> . Fair . Crown - Minor Deadwood < 100mm . Trunk - Basal Decay . Trunk - Partially occluded wound . Trunk - Old pruning wounds . Trunk - Leaning 	None Recorded..	No action required
Overall Total:									403 trees

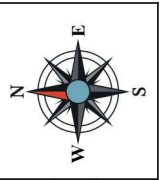
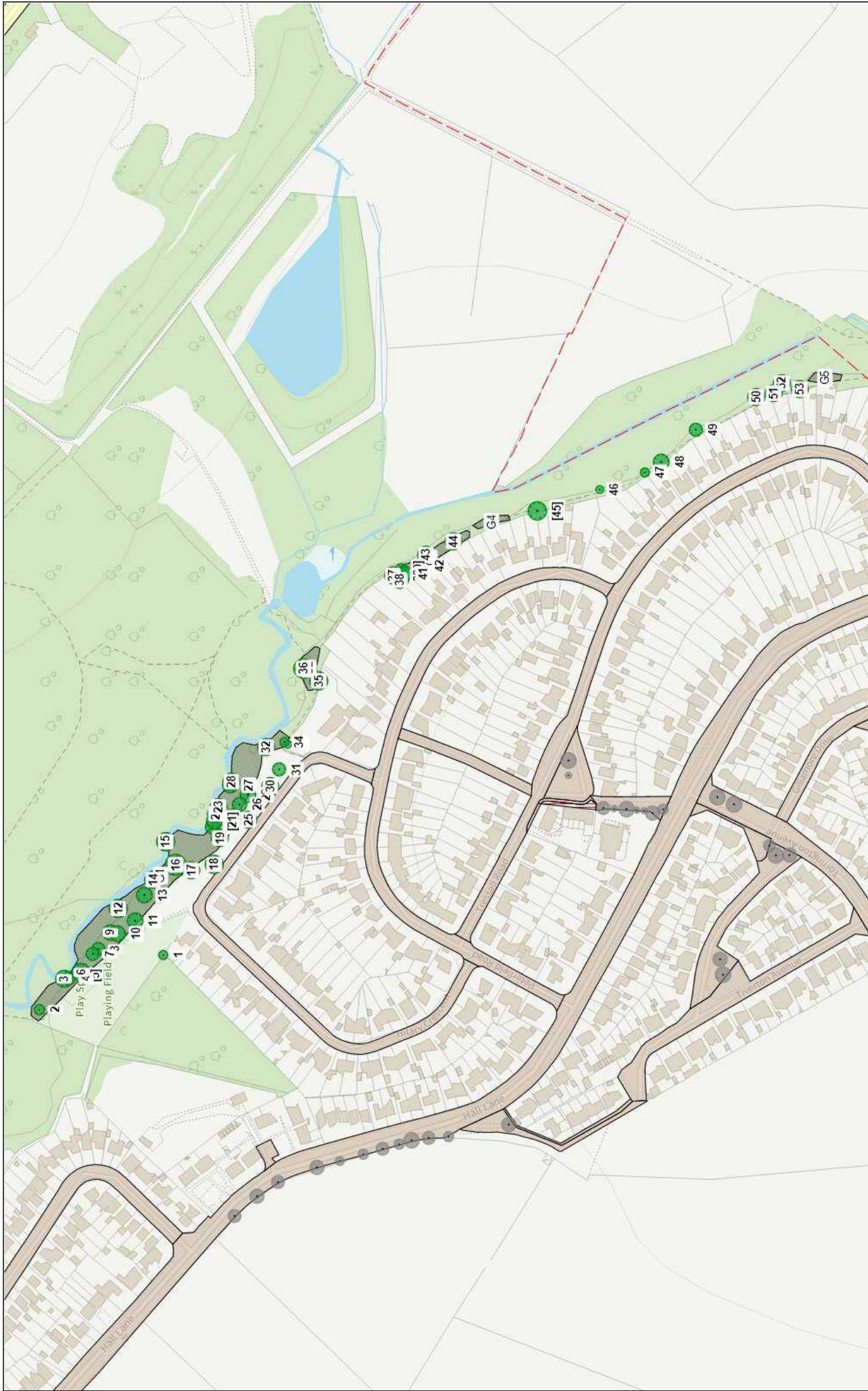

Scale	1: 1297
Date	27/04/2026

Overview

Reproduced from the Ordnance Survey mapping with the permission of the Controller of Her Majesty's Stationery Office. © Crown Copyright Reserved. Unauthorised reproduction infringes Crown Copyright and may lead to prosecution or civil proceedings.



Tree Code	Seq No	Common Name	what3words	Height(m)	Spread(m (dl))	Age Class	Features	Conditions	Recommendations	Priority
Location: Whitwick, NWL										
Site: Hilary Crescent Open Space 012										
14526	G1	Mixed Broadleaves	///lined.dogs.remarks	0	0	Mature	<ul style="list-style-type: none"> · Hazards - Bank / Slope / Terrain / Gradient · Wildlife: Habitat · Wildlife: Bat Roosts 	· Fair	<ul style="list-style-type: none"> · Straight Fell - clear 2x fallen stems at North West end of group adjacent gated access and fallen Poplar roughly opposite 52 fallen across stream (x 2 tree) 	Priority 2
14531	G2	Mixed Broadleaves	///edges.fine.savings	15	10	Middle-Aged	None Recorded..	<ul style="list-style-type: none"> · Fair · Trunk - Ivy/Climber 	<ul style="list-style-type: none"> · Section Fell - fell 2x Ash to rear of 39 Petersfields paint marked (x 2 tree) 	Priority 2
14379	6	Common Ash	///tamed.crush.ritual	19	14	Mature	None Recorded..	<ul style="list-style-type: none"> · Fair · Crown - Minor Deadwood < 100mm · Crown - Tearout wound · Trunk - Ivy/Climber · Trunk - Forked Trunk 	<ul style="list-style-type: none"> · General Works · Cut Ivy (No Price) 	Routine

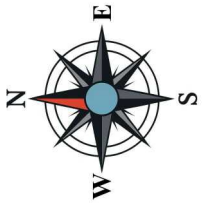
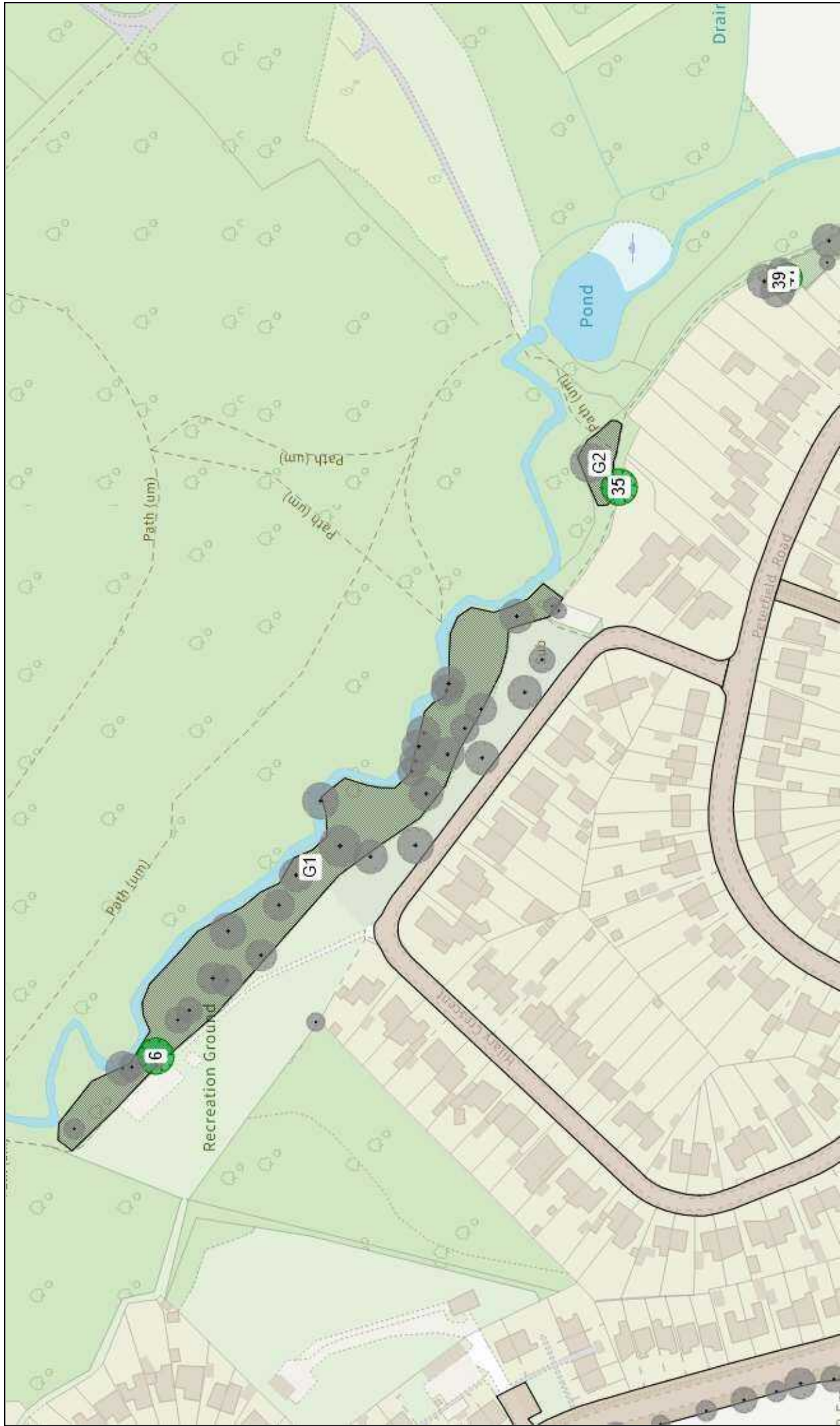

Scale	1: 1328
Date	27/04/2026

Overview

Reproduced from the Ordnance Survey mapping with the permission of the Controller of Her Majesty's Stationery Office. (c) Crown Copyright Reserved. Unauthorised reproduction infringes Crown Copyright and may lead to prosecution or civil proceedings.



Tree Code	Seq No	Common Name	what:3words	Height(m)	Spread(m (d))	Age Class	Conditions	Recommendations	Priority
Site: North Street Open Space 015									
Location: Whitwick, NWL									
14402	1	Pink Japanese Cherry	///probe.grass.fairly	9	8	Young-Mature	<ul style="list-style-type: none"> · Dying · Crown - Major Deadwood >100mm · Crown - Major Branch Dieback · Trunk - Multi-stemmed · Trunk - Surface Bark Wound · Trunk - Fungus - Ganoderma · Roots - Surface Root Damage 	<ul style="list-style-type: none"> · Section Fell · Stump chip 1200-1800mm 450mm deep 	Priority 2
14407	2	Pink Japanese Cherry	///models.cracks.staple	9	8	Young-Mature	<ul style="list-style-type: none"> · Poor · Crown - Major Deadwood >100mm · Crown - Major Branch Dieback · Trunk - Multi-stemmed · Trunk - Major Trunk Decay · Trunk - Fungus - Ganoderma 	<ul style="list-style-type: none"> · Section Fell · Stump chip 1200-1800mm 450mm deep 	Priority 2

Overall Total: 2 trees

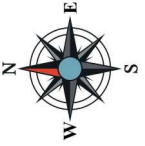

Scale	1: 133
Date	09/04/2026

Overview



Reproduced from the Ordnance Survey mapping with the permission of the Controller of Her Majesty's Stationery Office. (c) Crown Copyright Reserved. Unauthorised reproduction infringes Crown Copyright and may lead to prosecution or civil proceedings.



FORESTRY AND ARBORICULTURAL GROUP TREE REPORT

North Street Open Space

Whitwick

17th April 2026

SURVEYOR: Rob Hardingham



CONTENTS

- 1 General Tree Statement
- 2 Tree Works
- 3 Recommendations
- 4 Appendices

Included separately to this report.

- Tree survey schedule
- Site Maps

PURPOSE

This report has been prepared for Harby North Street Open Space as part of the tree safety survey conducted on 06th March 2026. It includes two individual trees spread over the site.

Details for the individual trees may be found in the separate accompanying schedule.

SURVEY METHODOLOGY

The survey has been conducted from ground level and has included a close visual inspection of the external features of all significant trees on the site. The trees are plotted and numbered on the enclosed plans and details of each individual tree are given on the survey schedule attached.

Where an identified defect represents a potential hazard to users of the site, recommendations for remedial tree work have been detailed against individual trees. These works have been prioritised into the categories specified below and are detailed within the attached schedule.

FINDINGS

Recommendations for remedial works have been made in the survey under Priority 2 works only. These trees have been identified as requiring attention at the time of the survey. You are advised to take the necessary steps to arrange for the recommended work to be completed.

'High Risk' trees are large trees close to busy areas with one or more significant defects that potentially threaten the structural integrity of the tree. These trees may be required to be re-inspected every 18 months. Any trees in this category will be highlighted in the report. All trees on this site (unless otherwise stated) should be considered as 'Moderate Risk' due to the open public aspect of the site and re-inspected every 3 years.

Routine works are those that may be picked up as part of your routine ground's maintenance cycle over three years. In some cases, these may be works that could be carried out by your own ground staff at no additional cost.

All trees should be kept routinely clear of ivy so that any evidence of poor health or safety concerns can be identified. Where trees have not been inspected due to excessive ivy, it is possible that they may not be covered by your insurance in the event of an incident. They should therefore be cleared and booked in for re-inspection as soon as possible.

1. GENERAL TREE STATEMENT

Two individual trees were surveyed and were generally found to be in poor health for their age, species and context.

Works have been recommended to remove both trees on the site. Replanting at this site should be considered, as the two trees recommended for removal are currently the only trees on site.

It is not known whether the trees on site are subject to any Tree Preservation Orders or Conservation Orders, and you should check with your local planning authority that necessary permissions are in place prior to commencing any maintenance work on the trees.

Trees of Note:

None

2. TREE WORKS

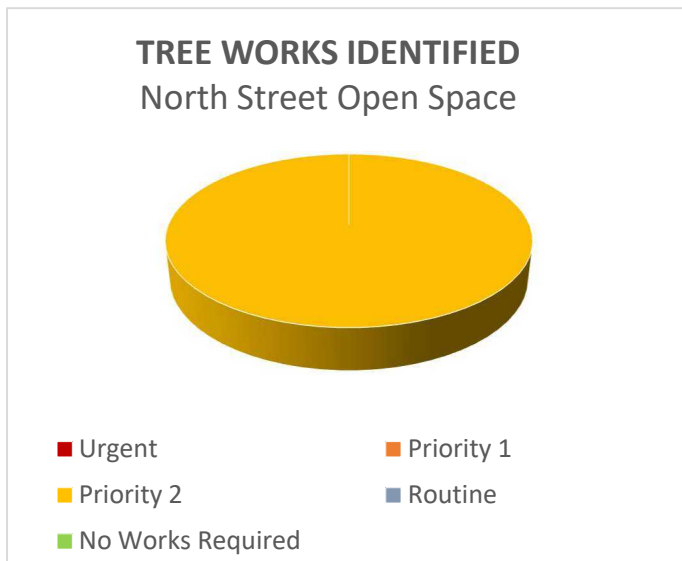

TREE NUMBERS	
URGENT	0
PRIORITY 1	0
PRIORITY 2	2
ROUTINE	0

Urgent Works – There are currently no urgent works to be undertaken.

Priority 1 – Remedial Health and Safety works to be completed within 3 months of report.

Priority 2 – Remedial Health and Safety works to be completed within 1 year of report.

Routine – Routine works to be completed within 3 years or as part of your regular grounds' maintenance.

The priority ratings provide an indication of how quickly recommended works should be carried out. Where you have a number of large, mature trees on site and increased costs, you may wish to prioritise those trees located within high impact areas.

NB. Quotes for recommended works can be obtained from LCC contractors upon request.

3. KEY RECOMMENDATIONS

- A full list of detailed tree management work recommendations is identified in the schedule and should be carried out as the priority states.

4. APPENDICIES

I) TREE SURVEYS

- The survey has included a close visual inspection of the external features of all significant trees on the site.
- The trees were inspected from ground level with no climbing inspections undertaken. No samples have been removed from the site for analysis.
- It should be noted that it is a criminal offence to disturb or destroy – whether intentional or unintentional - the nesting sites of wild birds or the roost sites of bats, under the 'Wildlife & Countryside Act 1981 and the 'Countryside and Rights of Way Act 2000'. It is not permitted to carry out significant tree works if active bird nests or bat roosts are present, and trees must be professionally surveyed for signs of bat roosts and/or bat activity before any tree works commence.

RE-INSPECTION PROCEDURE

It is important that trees are regularly inspected to monitor condition and identify any necessary remedial works. It is recommended that the following reinspection schedule should apply:

- **High Risk Trees**- re-inspections will take place every 18 months.
- **Moderate Risk Trees** - re-inspections every three years
- **Low Risk Trees** - re-inspections every six years

All trees should be included in formal routine (i.e., annual) risk assessments carried out by a suitably competent member of the site staff – an additional risk assessment should always be undertaken immediately following severe weather events i.e., high winds, heavy rain or snow falls. If in doubt regarding the safety of a particular tree, please contact the County Council's Forestry Group.

TREE WORKS

- All tree works should be carried out in line with British Standard 3998:2010 – “British Standard Recommendations for Tree Works”.
- Stump chipping will only be included for stumps of felled trees where these are considered to be a hazard. (e.g., adjacent to thoroughfares). You may, however, wish to consider removing other stumps on the site if you are concerned that they may be an obstruction or potential hazard.
- Should you choose to make your own arrangements, all works should be carried out by a competent, suitably qualified and appropriately insured arboricultural contractor in accordance with the British Standard. You should have regard to your ‘duty of care’ under the Health and Safety at Work Act 1974 when directly employing tree-work contractors, and your potential liability if damage or injury occurs because of poor practices.
- If the trees proposed for work are included in any statutory protection (e.g., tree preservation orders) no intervention should take place until written permission has been obtained from the relevant authority.
- The trees inspected and detailed within this report have been selected for inclusion due to their influence on the site. Where works have been recommended to trees outside the ownership of the site, these can only progress with the agreement of the owner, except where it involves parts of the trees overhanging the boundary.

LIMITATIONS

Tree inspection reports are subject to the following limitations:

- Given the dynamic nature of trees and their environment, the condition of the trees could alter at any time. All trees should be inspected by the owners on an annual basis and any recorded findings of concerns be reported to the County Council’s Forestry Group.
- Where trees are visually obscured (e.g., ivy) they should be made visible before a full visual inspection can take place. Any limitations of the assessment will be highlighted in the report.
- The validity, accuracy and findings of this report will be directly related to the accuracy of the information made available prior to and during its production. Leicestershire County Council will not be responsible for the recommendations within this report where essential data is not made available or is inaccurate.
- This report is valid as of the date of inspection, and only whilst site conditions remain unaltered. It may become invalid if for example construction works or changes in soil level take place in close proximity to the tree or trees concerned.
- It must also be appreciated that recommendations proposed within this report may be superseded by extreme weather, or any other unreasonably foreseeable events. Trees should be internally inspected after adverse weather conditions and any changes reported to the County Council’s Forestry Group.

If you would like further advice with regard to the survey or would like to arrange for the recommended work to be carried out, please contact Rob Hardingham (rob.hardingham@leics.gov.uk). Records of works to your trees can then be maintained and updated accordingly on our dedicated tree management database.

II) TREE SURGERY AND MAINTENANCE

GLOSSARY OF TERMS

The following terms, which may be included in your tree survey, relate to tree surgery and felling operations as defined in the County Council's forestry and arboricultural specifications and in British Standard 3998:2010 'Recommendations for Tree Work': -

- General Works* – this operation consists of a number of basic maintenance tasks including the removal of suckers, basal growth and dense shoot growth from the trunk of the tree, repair of minor bark wounds, removal of foreign debris, removal of minor branches which obstruct overhead services and access and the severance of climbing plants such as Ivy.
- Crown Lifting* - this operation consists of the removal of lower branches, twigs and dense shoot growth from the trunk of the tree in order to increase the clearance under its canopy.
- Cleaning Out* - the removal of dead, dying, diseased and irreparably damaged branches from throughout the crown of the tree.
- Crown Thinning* - the removal of a proportion of secondary lateral branches from the main branch structure of the tree to achieve an increase in light penetration through the crown and lessen the degree of resistance in windy conditions.
- Crown Reduction* - this operation includes the reduction in the overall height and spread of a tree whilst retaining a natural shape to its crown, typical of the species.
- Formative Pruning* - the selective pruning of the tree in order to promote the development of a well-formed mature specimen of a shape, habit and branch structure typical of the species.
- Further Investigation* - a more detailed and precise analysis of inaccessible areas, internal cavities, compressed forks etc.
- Pollarding* - this operation consists of a substantial reduction in the height and/or spread of a tree's crown to a point from where a new crown may develop. This is often carried out to remove potential weak points and is a method of management which needs to be repeated at regular intervals.
- Straight Felling* - the felling of a whole tree in one operation.
- Sectional Felling* - the felling/dismantling of a tree in sections of a size appropriate to the location so as to avoid damage to surrounding features.

If you require any further clarification of the recommendations detailed in your tree survey, please contact the Forestry Group on 0116 3056920.



FORESTRY AND ARBORICULTURAL GROUP TREE REPORT

Swannymote Road Open Space

Whitwick

17th April 2026

SURVEYOR: Rob Hardingham



CONTENTS

- 1 General Tree Statement
- 2 Tree Works
- 3 Recommendations
- 4 Appendices

Included separately to this report.

- Tree survey schedule
- Site Maps

PURPOSE

This report has been prepared for Swannymote Road Open Space as part of the tree safety survey conducted on 08th March 2026. It includes twenty-three individual trees, and one tree group spread over the site.

Details for the individual trees may be found in the separate accompanying schedule.

SURVEY METHODOLOGY

The survey has been conducted from ground level and has included a close visual inspection of the external features of all significant trees on the site. The trees are plotted and numbered on the enclosed plans and details of each individual tree are given on the survey schedule attached.

Where an identified defect represents a potential hazard to users of the site, recommendations for remedial tree work have been detailed against individual trees. These works have been prioritised into the categories specified below and are detailed within the attached schedule.

FINDINGS

Recommendations for remedial works have been made in the survey under Priority 1 and Priority 2 works only. These trees have been identified as requiring attention at the time of the survey. You are advised to take the necessary steps to arrange for the recommended work to be completed.

'High Risk' trees are large trees close to busy areas with one or more significant defects that potentially threaten the structural integrity of the tree. These trees may be required to be re-inspected every 18 months. Any trees in this category will be highlighted in the report. All trees on this site (unless otherwise stated) should be considered as 'Moderate Risk' due to the open public aspect of the site and re-inspected every 3 years.

Routine works are those that may be picked up as part of your routine ground's maintenance cycle over three years. In some cases, these may be works that could be carried out by your own ground staff at no additional cost.

All trees should be kept routinely clear of ivy so that any evidence of poor health or safety concerns can be identified. Where trees have not been inspected due to excessive ivy, it is possible that they may not be covered by your insurance in the event of an incident. They should therefore be cleared and booked in for re-inspection as soon as possible.

1. GENERAL TREE STATEMENT

Twenty-three individual trees and one tree group were surveyed and were generally found to be in good health for their age, species and context. There are a number of mature trees on site which exhibit a range of characteristics commensurate with their age and maturity.

Works have been recommended to six trees on the site. Some trees would benefit from the removal of excessive ivy which increases the risk of failure due to excess weight on weak limbs and places excessive stress on the trees' anchorage in windy conditions, it may also prevent a comprehensive tree inspection and should therefore be removed annually whilst the ivy is small and accessible.

It is not known whether the trees on site are subject to any Tree Preservation Orders or Conservation Orders, and you should check with your local planning authority that necessary permissions are in place prior to commencing any maintenance work on the trees.

Trees of Note:

None

2. TREE WORKS

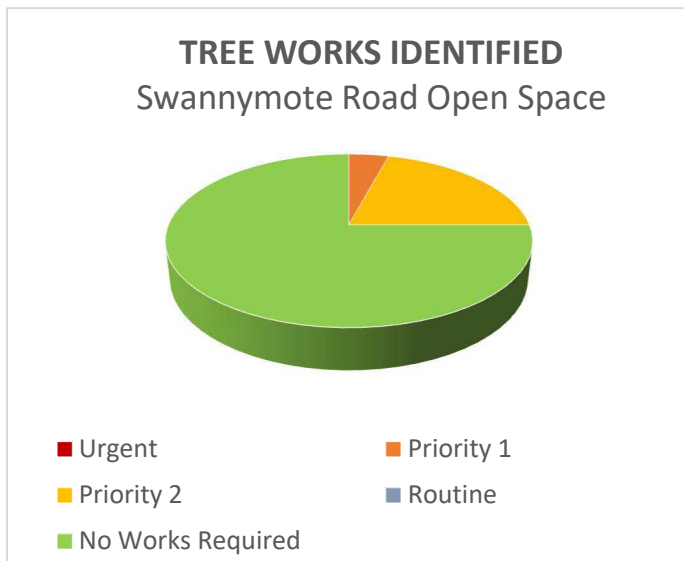

TREE NUMBERS	
URGENT	0
PRIORITY 1	1
PRIORITY 2	5
ROUTINE	0

Urgent Works – There are currently no urgent works to be undertaken.

Priority 1 – Remedial Health and Safety works to be completed within 3 months of report.

Priority 2 – Remedial Health and Safety works to be completed within 1 year of report.

Routine – Routine works to be completed within 3 years or as part of your regular grounds' maintenance.

The priority ratings provide an indication of how quickly recommended works should be carried out. Where you have a number of large, mature trees on site and increased costs, you may wish to prioritise those trees located within high impact areas.

NB. Quotes for recommended works can be obtained from LCC contractors upon request.

3. KEY RECOMMENDATIONS

- A full list of detailed tree management work recommendations is identified in the schedule and should be carried out as the priority states.
- The removal of the broken branch from T5

4. APPENDICIES

I) TREE SURVEYS

- The survey has included a close visual inspection of the external features of all significant trees on the site.
- The trees were inspected from ground level with no climbing inspections undertaken. No samples have been removed from the site for analysis.
- It should be noted that it is a criminal offence to disturb or destroy – whether intentional or unintentional - the nesting sites of wild birds or the roost sites of bats, under the 'Wildlife & Countryside Act 1981 and the 'Countryside and Rights of Way Act 2000'. It is not permitted to carry out significant tree works if active bird nests or bat roosts are present, and trees must be professionally surveyed for signs of bat roosts and/or bat activity before any tree works commence.

RE-INSPECTION PROCEDURE

It is important that trees are regularly inspected to monitor condition and identify any necessary remedial works. It is recommended that the following reinspection schedule should apply:

- **High Risk Trees**- re-inspections will take place every 18 months.
- **Moderate Risk Trees** - re-inspections every three years
- **Low Risk Trees** - re-inspections every six years

All trees should be included in formal routine (i.e., annual) risk assessments carried out by a suitably competent member of the site staff – an additional risk assessment should always be undertaken immediately following severe weather events i.e., high winds, heavy rain or snow falls. If in doubt regarding the safety of a particular tree, please contact the County Council's Forestry Group.

TREE WORKS

- All tree works should be carried out in line with British Standard 3998:2010 – “British Standard Recommendations for Tree Works”.
- Stump chipping will only be included for stumps of felled trees where these are considered to be a hazard. (e.g., adjacent to thoroughfares). You may, however, wish to consider removing other stumps on the site if you are concerned that they may be an obstruction or potential hazard.
- Should you choose to make your own arrangements, all works should be carried out by a competent, suitably qualified and appropriately insured arboricultural contractor in accordance with the British Standard. You should have regard to your ‘duty of care’ under the Health and Safety at Work Act 1974 when directly employing tree-work contractors, and your potential liability if damage or injury occurs because of poor practices.
- If the trees proposed for work are included in any statutory protection (e.g., tree preservation orders) no intervention should take place until written permission has been obtained from the relevant authority.
- The trees inspected and detailed within this report have been selected for inclusion due to their influence on the site. Where works have been recommended to trees outside the ownership of the site, these can only progress with the agreement of the owner, except where it involves parts of the trees overhanging the boundary.

LIMITATIONS

Tree inspection reports are subject to the following limitations:

- Given the dynamic nature of trees and their environment, the condition of the trees could alter at any time. All trees should be inspected by the owners on an annual basis and any recorded findings of concerns be reported to the County Council’s Forestry Group.
- Where trees are visually obscured (e.g., ivy) they should be made visible before a full visual inspection can take place. Any limitations of the assessment will be highlighted in the report.
- The validity, accuracy and findings of this report will be directly related to the accuracy of the information made available prior to and during its production. Leicestershire County Council will not be responsible for the recommendations within this report where essential data is not made available or is inaccurate.
- This report is valid as of the date of inspection, and only whilst site conditions remain unaltered. It may become invalid if for example construction works or changes in soil level take place in close proximity to the tree or trees concerned.
- It must also be appreciated that recommendations proposed within this report may be superseded by extreme weather, or any other unreasonably foreseeable events. Trees should be internally inspected after adverse weather conditions and any changes reported to the County Council’s Forestry Group.

If you would like further advice with regard to the survey or would like to arrange for the recommended work to be carried out, please contact Rob Hardingham (rob.hardingham@leics.gov.uk). Records of works to your trees can then be maintained and updated accordingly on our dedicated tree management database.

II) TREE SURGERY AND MAINTENANCE

GLOSSARY OF TERMS

The following terms, which may be included in your tree survey, relate to tree surgery and felling operations as defined in the County Council's forestry and arboricultural specifications and in British Standard 3998:2010 'Recommendations for Tree Work': -

- General Works* – this operation consists of a number of basic maintenance tasks including the removal of suckers, basal growth and dense shoot growth from the trunk of the tree, repair of minor bark wounds, removal of foreign debris, removal of minor branches which obstruct overhead services and access and the severance of climbing plants such as Ivy.
- Crown Lifting* - this operation consists of the removal of lower branches, twigs and dense shoot growth from the trunk of the tree in order to increase the clearance under its canopy.
- Cleaning Out* - the removal of dead, dying, diseased and irreparably damaged branches from throughout the crown of the tree.
- Crown Thinning* - the removal of a proportion of secondary lateral branches from the main branch structure of the tree to achieve an increase in light penetration through the crown and lessen the degree of resistance in windy conditions.
- Crown Reduction* - this operation includes the reduction in the overall height and spread of a tree whilst retaining a natural shape to its crown, typical of the species.
- Formative Pruning* - the selective pruning of the tree in order to promote the development of a well-formed mature specimen of a shape, habit and branch structure typical of the species.
- Further Investigation* - a more detailed and precise analysis of inaccessible areas, internal cavities, compressed forks etc.
- Pollarding* - this operation consists of a substantial reduction in the height and/or spread of a tree's crown to a point from where a new crown may develop. This is often carried out to remove potential weak points and is a method of management which needs to be repeated at regular intervals.
- Straight Felling* - the felling of a whole tree in one operation.
- Sectional Felling* - the felling/dismantling of a tree in sections of a size appropriate to the location so as to avoid damage to surrounding features.

If you require any further clarification of the recommendations detailed in your tree survey, please contact the Forestry Group on 0116 3056920.

Tree Code	Seq No	Common Name	what3words	Height(m)	Spread(m (dl))	Age Class	Conditions	Recommendations	Priority
Site: Swannymote Road Open Space 017									
Location: Whitwick, NWL									
13949	G1	Mixed Broadleaves	///that.bleat.coach	13	9	Young-Mature	· Fair	None Recorded..	No action required
13919	1	English Oak	///necks.sudden.clues	14	11	Young-Mature	· Fair · Crown - Minor Deadwood < 100mm · Trunk - Forked Trunk · Trunk - Partially occluded wound	None Recorded..	No action required
13804	2	English Oak	///useful.causes.smile	13	13	Middle-Aged	· Fair · Crown - Previous crown reduction · Crown - Tearout wound · Crown - Branch wounds	None Recorded..	No action required
13809	3	English Oak	///jobs.begin.saving	14	10	Young-Mature	· Fair · Crown - Minor Deadwood < 100mm · Trunk - Partially occluded wound	None Recorded..	No action required
13814	4	English Oak	///hero.cages.paid	13	11	Young-Mature	· Fair · Crown - Minor Deadwood < 100mm · Crown - Low Branches	None Recorded..	No action required
13819	5	English Oak	///along.fork.thick	16	14	Middle-Aged	· Fair · Crown - Minor Deadwood < 100mm · Crown - Broken Hanging Branches · Trunk - Forked Trunk · Trunk - Minor Trunk Decay · Trunk - Trunk Cavity · Trunk - Crack/split · Trunk - Partially occluded wound	· None Recorded.. · General Works · Clean Out - remove broken branch over highway	Priority 1
13824	6	English Oak	///darker.swing.combining	13	13	Middle-Aged	· Fair · Crown - Minor Deadwood < 100mm · Crown - Low Branches · Crown - Suppressed	None Recorded..	No action required
13829	7	English Oak	///encounter.flats.hiding	14	12	Young-Mature	· Fair · Crown - Minor Deadwood < 100mm · Crown - Low Branches	None Recorded..	No action required
13834	8	English Oak	///open.noble.looks	15	12	Young-Mature	· Fair · Crown - Minor Deadwood < 100mm · Trunk - Forked Trunk	None Recorded..	No action required
13839	9	English Oak	///wires.wonderfully.impact	16	12	Young-Mature	· Fair · Crown - Minor Deadwood < 100mm · Trunk - Forked Trunk · Trunk - Included Bark · Trunk - Weak Unions	None Recorded..	No action required

Tree Code	Seq No	Common Name	what3words	Height(m)	Spread(m (dl))	Age Class	Conditions	Recommendations	Priority
Site: Swannymote Road Open Space 017									
Location: Whitwick, NWL									
13844	10	English Oak	///paint.drips.noises	14	10	Middle-Aged	<ul style="list-style-type: none"> · Fair · Crown - Major Deadwood >100mm · Crown - Broken Hanging Branches 	<ul style="list-style-type: none"> · General Works · Clean Out - remove dead wood and broken branch 	Priority 2
13924	11	English Oak	///driven.pump.free	13	8	Young-Mature	<ul style="list-style-type: none"> · Poor · Crown - Major Deadwood >100mm · Crown - Major Branch Dieback · Crown - Crown density 0% to 25% intact · Crown - Branch Decay · Crown - Branch wounds 	<ul style="list-style-type: none"> · Section Fell 	Priority 2
13849	12	English Oak	///rigid.escape.wire	15	13	Middle-Aged	<ul style="list-style-type: none"> · Fair · Crown - Major Deadwood >100mm · Crown - Low Branches 	<ul style="list-style-type: none"> · None Recorded.. 	No action required
13854	13	English Oak	///rigid.escape.wire	16	12	Middle-Aged	<ul style="list-style-type: none"> · Fair · Crown - Minor Deadwood < 100mm 	<ul style="list-style-type: none"> · None Recorded.. 	No action required
13859	14	English Oak	///stick.sadly.forget	15	13	Middle-Aged	<ul style="list-style-type: none"> · Fair · Crown - Major Deadwood >100mm · Crown - Broken Hanging Branches 	<ul style="list-style-type: none"> · General Works · Clean Out - remove broken branch 	Priority 2
13929	15	Turkey Oak	///lake.props.filed	19	13	Middle-Aged	<ul style="list-style-type: none"> · Good · Crown - Minor Deadwood < 100mm 	<ul style="list-style-type: none"> · None Recorded.. 	No action required
13864	16	English Oak	///sudden.saying.linked	15	12	Young-Mature	<ul style="list-style-type: none"> · Fair · Crown - Minor Deadwood < 100mm 	<ul style="list-style-type: none"> · None Recorded.. 	No action required
13869	17	English Oak	///inner.coherent.comet	16	14	Middle-Aged	<ul style="list-style-type: none"> · Fair · Crown - Minor Deadwood < 100mm · Trunk - Multi-stemmed 	<ul style="list-style-type: none"> · None Recorded.. 	No action required
13874	18	English Oak	///begin.season.fight	16	14	Middle-Aged	<ul style="list-style-type: none"> · Fair · Crown - Minor Deadwood < 100mm 	<ul style="list-style-type: none"> · None Recorded.. 	No action required
13934	19	Goat Willow	///fend.jolly.weds	6	4	Young-Mature	<ul style="list-style-type: none"> · Poor · Crown - Recently pollarded 	<ul style="list-style-type: none"> · None Recorded.. 	No action required
13939	20	Goat Willow	///vocal.crowned.motion	9	11	Young-Mature	<ul style="list-style-type: none"> · Poor · Crown - Major Deadwood >100mm · Crown - Major Branch Dieback · Trunk - Forked Trunk · Roots - Rootplate Movement 	<ul style="list-style-type: none"> · None Recorded.. 	No action required

Tree Code	Seq No	Common Name	what3words	Height(m)	Spread(m (dl))	Age Class	Conditions	Recommendations	Priority
Site: Swannymote Road Open Space 017									
Location: Whitwick, NWL									
13944	21	Goat Willow	///cult.ahead.shiny	14	11	Young-Mature	<ul style="list-style-type: none"> · Poor · Crown - Broken Hanging Branches · Trunk - Epicormics/suckers · Trunk - Forked Trunk · Trunk - Minor Trunk Decay 	<ul style="list-style-type: none"> · General Works · Pollard - at 3m 	Priority 2
13879	22	English Oak	///cracks.tame.hints	15	12	Middle-Aged	<ul style="list-style-type: none"> · Fair · Crown - Minor Deadwood < 100mm · Crown - Low Branches · Crown - Broken Hanging Branches · Trunk - Forked Trunk 	<ul style="list-style-type: none"> · General Works · Clean Out - remove broken branches 	Priority 2
13884	23	English Oak	///fats.less.wings	17	13	Middle-Aged	<ul style="list-style-type: none"> · Fair · Crown - Minor Deadwood < 100mm · Trunk - Forked Trunk 	<ul style="list-style-type: none"> · None Recorded. 	No action required
Overall Total:									143 trees



Overview



Reproduced from the Ordnance Survey mapping with the permission of the Controller of Her Majesty's Stationery Office. (c) Crown Copyright Reserved. Unauthorised reproduction infringes Crown Copyright and may lead to prosecution or civil proceedings.

Tree Code	Seq No	Common Name	what3words	Height(m)	Spread(m (dl))	Age Class	Features	Conditions	Recommendations	Priority
Location: Whitwick, NWL										
Site: Swannymote Road Open Space 017										
13819	5	English Oak	///along.fork.thick	16	14	Middle-Aged	<ul style="list-style-type: none"> · Adjacent - Road · Adjacent - Parking area 	<ul style="list-style-type: none"> · Fair · Crown - Minor · Deadwood < 100mm · Crown - Broken Hanging Branches · Trunk - Forked Trunk · Trunk - Minor · Trunk Decay · Trunk - Trunk Cavity · Trunk - Crack/split · Trunk - Partially occluded wound 	<ul style="list-style-type: none"> · General Works · Clean Out - remove broken branch over highway 	Priority 1
13844	10	English Oak	///paint.drips.noises	14	10	Middle-Aged	<ul style="list-style-type: none"> · Hazard: Footpath under crown 	<ul style="list-style-type: none"> · Fair · Crown - Major · Deadwood >100mm · Crown - Broken Hanging Branches 	<ul style="list-style-type: none"> · General Works · Clean Out - remove dead wood and broken branch 	Priority 2

Tree Code	Seq No	Common Name	what3words	Height(m)	Spread(m (dl))	Age Class	Features	Conditions	Recommendations	Priority
Location: Whitwick, NWL										
Site: Swannymote Road Open Space 017										
13924	11	English Oak	///driven.pump.free	13	8	Young-Mature	None Recorded..	<ul style="list-style-type: none"> · Poor · Crown - Major Deadwood >100mm · Crown - Major Branch Dieback · Crown - Crown density 0% to 25% intact · Crown - Branch Decay · Crown - Branch wounds 	<ul style="list-style-type: none"> · Section Fell 	Priority 2
13859	14	English Oak	///stick.sadly.forget	15	13	Middle-Aged	<ul style="list-style-type: none"> · Growing In - Boundary 	<ul style="list-style-type: none"> · Fair · Crown - Major Deadwood >100mm · Crown - Broken Hanging Branches 	<ul style="list-style-type: none"> · General Works · Clean Out - remove broken branch 	Priority 2
13944	21	Goat Willow	///cult.ahead.shiny	14	11	Young-Mature	None Recorded..	<ul style="list-style-type: none"> · Poor · Crown - Broken Hanging Branches · Trunk - Epicomics/suckers · Trunk - Forked Trunk · Trunk - Minor Trunk Decay 	<ul style="list-style-type: none"> · General Works · Pollard - at 3m 	Priority 2

Tree Code	Seq No	Common Name	what3words	Height(m)	Spread(m (d))	Age Class	Features	Conditions	Recommendations	Priority
-----------	--------	-------------	------------	-----------	---------------	-----------	----------	------------	-----------------	----------

Location: Whitwick, NWL

Site: Swannymote Road Open Space 017

13879	22	English Oak	/// cracks.tame.hints	15	12	Middle-Aged	None Recorded..	<ul style="list-style-type: none"> · Fair · Crown - Minor Deadwood < 100mm · Crown - Low Branches · Crown - Broken Hanging Branches · Trunk - Forked Trunk 	<ul style="list-style-type: none"> · General Works · Clean Out - remove broken branches 	Priority 2
-------	----	-------------	--------------------------	----	----	-------------	-----------------	--	---	------------

Overall Total: 6 trees

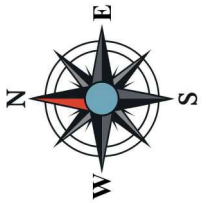
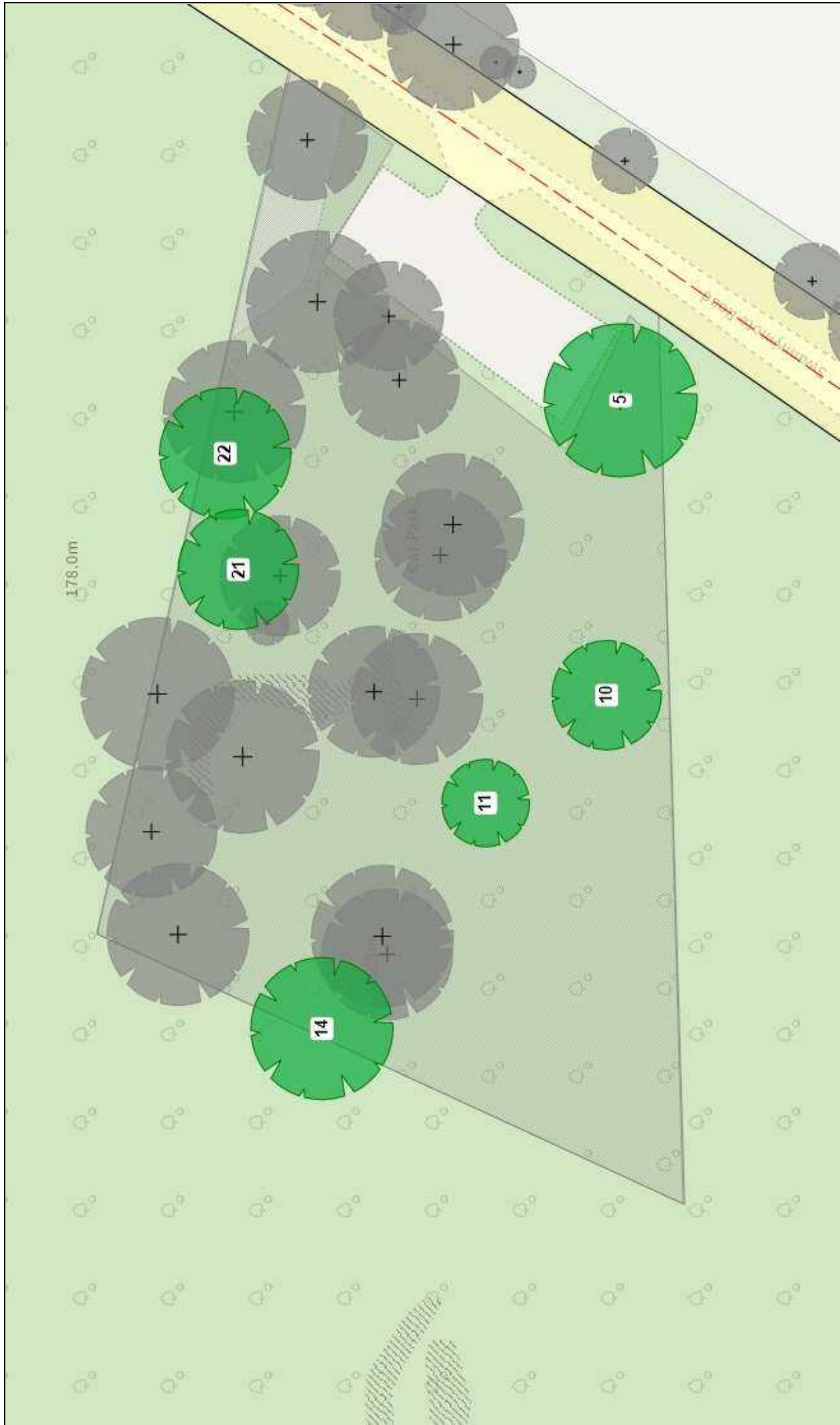

Scale	1: 344
Date	09/04/2026

Overview

Reproduced from the Ordnance Survey mapping with the permission of the Controller of Her Majesty's Stationery Office. (c) Crown Copyright Reserved. Unauthorised reproduction infringes Crown Copyright and may lead to prosecution or civil proceedings.



Tree Code	Seq No	Common Name	what3words	Height(m)	Spread(m (d))	Age Class	Conditions	Recommendations	Priority
Site: Walkers Flats Allotments and Field 003									
Location: Whitwick, NWL									
13818	G1	Mixed Broadleaves	///fries.sizes.juices	10	7	Young-Mature	· Fair	None Recorded..	No action required
13906	1	Wild Cherry	///hungry.buddy.blocks	13	9	Young-Mature	· Fair · Crown - Asymmetric Crown · Roots - Soil Level Raised	None Recorded..	No action required
13911	2	Wild Cherry	///rocks.shared.pencil	13	11	Young-Mature	· Fair · FELLED · Trunk - Forked Trunk	None Recorded..	No action required
13931	G2	Mixed Broadleaves	///dinner.sends.soap	10	7	Young-Mature	· Fair	None Recorded..	No action required
13803	3	Magnolia spp	///gifted.fallen.precautions	6	4	Young-Mature	· Good	None Recorded..	No action required
13916	4	English Oak	///winter.during.vibe	13	11	Young-Mature	· Good · Crown - Minor Deadwood < 100mm · Crown - Previous crown lift · Trunk - Partially occluded wound	None Recorded..	No action required
13808	5	English Oak	///baking.tiles.name	13	10	Young-Mature	· Good · Crown - Minor Deadwood < 100mm	None Recorded..	No action required
13813	6	English Oak	///clips.casual.verge	13	10	Young-Mature	· Good · Crown - Minor Deadwood < 100mm · Crown - Low Branches · Trunk - Ivy/Climber	None Recorded..	No action required
13921	7	Silver Birch	///ends.reader.spicy	16	11	Middle-Aged	· Good · Crown - Minor Deadwood < 100mm · Trunk - Ivy/Climber	None Recorded..	No action required
13926	8	Silver Birch	///fields.dive.stared	16	12	Middle-Aged	· Good · Crown - Minor Deadwood < 100mm · Trunk - Forked Trunk · Trunk - Partially occluded wound	None Recorded..	No action required
13823	9	Silver Birch	///dozen.picked.stuck	15	11	Middle-Aged	· Good · Crown - Minor Deadwood < 100mm · Trunk - Forked Trunk	None Recorded..	No action required
13828	10	Wild Cherry	///dots.pram.leaps	15	13	Middle-Aged	· Fair · Crown - Minor Deadwood < 100mm · Trunk - Ivy/Climber · Trunk - Forked Trunk	None Recorded..	No action required
13833	11	Apple spp	///powder.gosh.shin	2	3	Semi-Mature	· Good · FELLED	None Recorded..	No action required
13838	12	Apple spp	///thigh.places.year	1	3	Semi-Mature	· Good	None Recorded..	No action required
13843	13	Apple spp	///petal.chin.shirts	3	3	Semi-Mature	· Good · Crown - Low Branches · Trunk - Forked Trunk	None Recorded..	No action required

Tree Code	Seq No	Common Name	what3words	Height(m)	Spread(m (d))	Age Class	Conditions	Recommendations	Priority
Site: Walkers Flats Allotments and Field 003									
Location: Whitwick, NWL									
13848	14	Common Holly	///media.solved.lung	6	5	Young-Mature	· Good · Crown - Low Branches · Trunk - Epicormics/suckers	None Recorded..	No action required
13936	15	Goat Willow	///types.swift.mull	6	5	Young-Mature	· Fair · FELLED · Trunk - Forked Trunk · Trunk - Minor Trunk Decay	None Recorded..	No action required
Overall Total:									125 trees

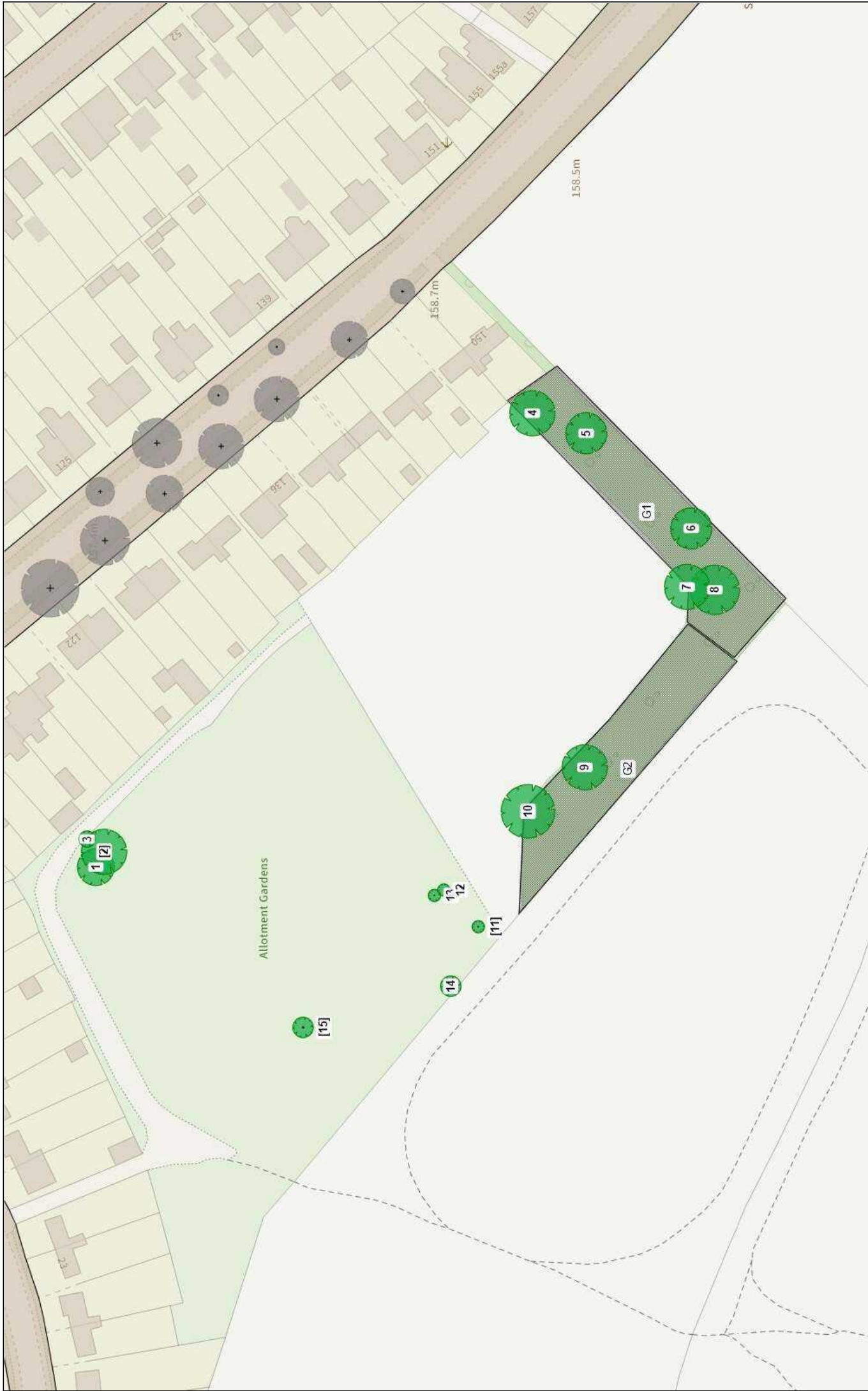



**FORESTRY AND ARBORICULTURAL GROUP
TREE REPORT**

Walkers Flats Allotments & Field

Whitwick

27th April 2026

SURVEYOR: Rob Hardingham



CONTENTS

- 1 General Tree Statement
- 2 Tree Works
- 3 Recommendations
- 4 Appendices

Included separately to this report.

- Tree survey schedule
- Site Maps

PURPOSE

This report has been prepared for Walkers Flats Allotments & Field as part of the tree safety survey conducted on 14th April 2026. It includes fifteen individual trees and two tree groups spread across the site.

Details for the individual trees may be found in the separate accompanying schedule.

SURVEY METHODOLOGY

The survey has been conducted from ground level and has included a close visual inspection of the external features of all significant trees on the site. The trees are plotted and numbered on the enclosed plans and details of each individual tree are given on the survey schedule attached.

Where an identified defect represents a potential hazard to users of the site, recommendations for remedial tree work have been detailed against individual trees. These works have been prioritised into the categories specified below and are detailed within the attached schedule.

FINDINGS

No Recommendations for remedial works have been made in the survey.

'High Risk' trees are large trees close to busy areas with one or more significant defects that potentially threaten the structural integrity of the tree. These trees may be required to be re-inspected every 18 months. Any trees in this category will be highlighted in the report.

All trees should be kept routinely clear of ivy so that any evidence of poor health or safety concerns can be identified. Where trees have not been inspected due to excessive ivy, it is possible that they may not be covered by your insurance in the event of an incident. They should therefore be cleared and booked in for re-inspection as soon as possible.

1. GENERAL TREE STATEMENT

Fifteen individual trees and two tree groups were surveyed and were generally found to be in good health for their age, species and context.

It is not known whether the trees on site are subject to any Tree Preservation Orders or Conservation Orders, and you should check with your local planning authority that necessary permissions are in place prior to commencing any maintenance work on the trees.

Trees of Note:

None

2. TREE WORKS

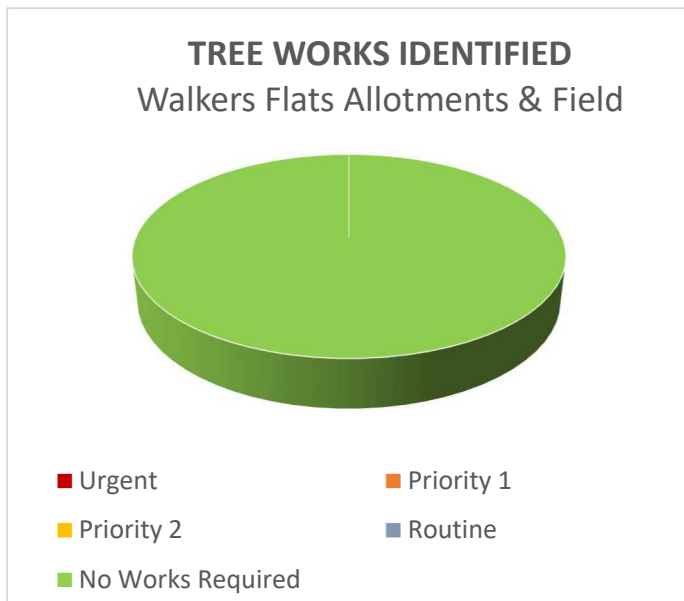

TREE NUMBER	
URGENT	0
PRIORITY 1	0
PRIORITY 2	0
ROUTINE	0

Urgent Works – There are currently no urgent works to be undertaken.

Priority 1 – Remedial Health and Safety works to be completed within 3 months of report.

Priority 2 – Remedial Health and Safety works to be completed within 1 year of report.

Routine – Routine works to be completed within 3 years or as part of your regular grounds' maintenance.

The priority ratings provide an indication of how quickly recommended works should be carried out. Where you have a number of large, mature trees on site and increased costs, you may wish to prioritise those trees located within high impact areas.

NB. Quotes for recommended works can be obtained from LCC contractors upon request.

3. KEY RECOMMENDATIONS

- No work is required at present on this site.

4. APPENDICIES

I) TREE SURVEYS

- The survey has included a close visual inspection of the external features of all significant trees on the site.
- The trees were inspected from ground level with no climbing inspections undertaken. No samples have been removed from the site for analysis.
- It should be noted that it is a criminal offence to disturb or destroy – whether intentional or unintentional - the nesting sites of wild birds or the roost sites of bats, under the 'Wildlife & Countryside Act 1981 and the 'Countryside and Rights of Way Act 2000'. It is not permitted to carry out significant tree works if active bird nests or bat roosts are present, and trees must be professionally surveyed for signs of bat roosts and/or bat activity before any tree works commence.

RE-INSPECTION PROCEDURE

It is important that trees are regularly inspected to monitor condition and identify any necessary remedial works. It is recommended that the following reinspection schedule should apply:

- **High Risk Trees**- re-inspections will take place every 18 months.
- **Moderate Risk Trees** - re-inspections every three years
- **Low Risk Trees** - re-inspections every six years

All trees should be included in formal routine (i.e., annual) risk assessments carried out by a suitably competent member of the site staff – an additional risk assessment should always be undertaken immediately following severe weather events i.e., high winds, heavy rain or snow falls. If in doubt regarding the safety of a particular tree, please contact the County Council's Forestry Group.

TREE WORKS

- All tree works should be carried out in line with British Standard 3998:2010 – “British Standard Recommendations for Tree Works”.
- Stump chipping will only be included for stumps of felled trees where these are considered to be a hazard. (e.g., adjacent to thoroughfares). You may, however, wish to consider removing other stumps on the site if you are concerned that they may be an obstruction or potential hazard.
- Should you choose to make your own arrangements, all works should be carried out by a competent, suitably qualified and appropriately insured arboricultural contractor in accordance with the British Standard. You should have regard to your ‘duty of care’ under the Health and Safety at Work Act 1974 when directly employing tree-work contractors, and your potential liability if damage or injury occurs because of poor practices.
- If the trees proposed for work are included in any statutory protection (e.g., tree preservation orders) no intervention should take place until written permission has been obtained from the relevant authority.
- The trees inspected and detailed within this report have been selected for inclusion due to their influence on the site. Where works have been recommended to trees outside the ownership of the site, these can only progress with the agreement of the owner, except where it involves parts of the trees overhanging the boundary.

LIMITATIONS

Tree inspection reports are subject to the following limitations:

- Given the dynamic nature of trees and their environment, the condition of the trees could alter at any time. All trees should be inspected by the owner on an annual basis and any recorded findings of concerns be reported to the County Council’s Forestry Group.
- Where trees are visually obscured (e.g., ivy) they should be made visible before a full visual inspection can take place. Any limitations of the assessment will be highlighted in the report.
- The validity, accuracy and findings of this report will be directly related to the accuracy of the information made available prior to and during its production. Leicestershire County Council will not be responsible for the recommendations within this report where essential data is not made available or is inaccurate.
- This report is valid as of the date of inspection, and only whilst site conditions remain unaltered. It may become invalid if for example construction works or changes in soil level take place in close proximity to the tree or trees concerned.
- It must also be appreciated that recommendations proposed within this report may be superseded by extreme weather, or any other unreasonably foreseeable events. Trees should be internally inspected after adverse weather conditions and any changes reported to the County Council’s Forestry Group.

If you would like further advice with regard to the survey or would like to arrange for the recommended work to be carried out, please contact Rob Hardingham (rob.hardingham@leics.gov.uk). Records of works to your trees can then be maintained and updated accordingly on our dedicated tree management database.

II) TREE SURGERY AND MAINTENANCE

GLOSSARY OF TERMS

The following terms, which may be included in your tree survey, relate to tree surgery and felling operations as defined in the County Council's forestry and arboricultural specifications and in British Standard 3998:2010 'Recommendations for Tree Work': -

- General Works* – this operation consists of a number of basic maintenance tasks including the removal of suckers, basal growth and dense shoot growth from the trunk of the tree, repair of minor bark wounds, removal of foreign debris, removal of minor branches which obstruct overhead services and access and the severance of climbing plants such as Ivy.
- Crown Lifting* - this operation consists of the removal of lower branches, twigs and dense shoot growth from the trunk of the tree in order to increase the clearance under its canopy.
- Cleaning Out* - the removal of dead, dying, diseased and irreparably damaged branches from throughout the crown of the tree.
- Crown Thinning* - the removal of a proportion of secondary lateral branches from the main branch structure of the tree to achieve an increase in light penetration through the it's crown and lessen the degree of resistance in windy conditions.
- Crown Reduction* - this operation includes the reduction in the overall height and spread of a tree whilst retaining a natural shape to its crown, typical of the species.
- Formative Pruning* - the selective pruning of the tree in order to promote the development of a well-formed mature specimen of a shape, habit and branch structure typical of the species.
- Further Investigation* - a more detailed and precise analysis of inaccessible areas, internal cavities, compressed forks etc.
- Pollarding* - this operation consists of a substantial reduction in the height and/or spread of a trees crown to a point from where a new crown may develop. This is often carried out to remove potential weak points and is a method of management which needs to be repeated at regular intervals.
- Straight Felling* - the felling of a whole tree in one operation.
- Sectional Felling* - the felling/dismantling of a tree in sections of a size appropriate to the location so as to avoid damage to surrounding features.

If you require any further clarification of the recommendations detailed in your tree survey, please contact the Forestry Group on 0116 3056920.